

G&L Pumps

CURVES
GL-599 R2

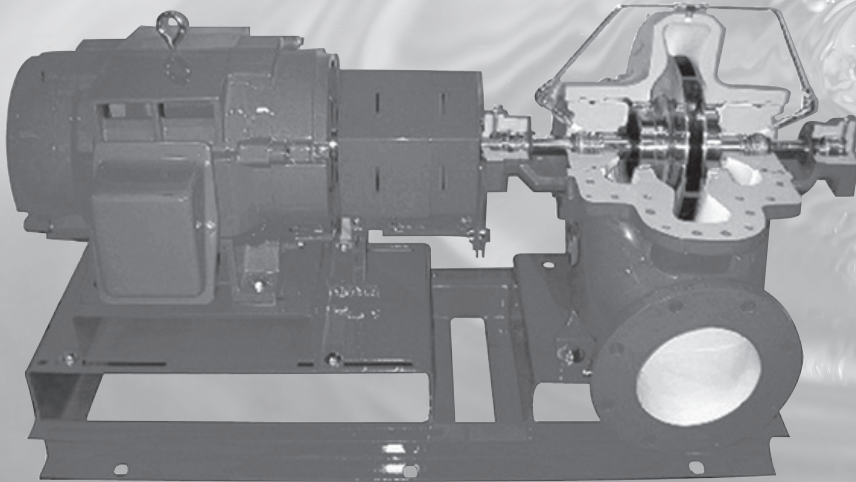

Series A-C 8100 60 Hz

HORIZONTAL SPLIT CASE BASE MOUNTED - DOUBLE SUCTION PUMP
PERFORMANCE CURVES

xylem
Let's Solve Water

TABLE OF CONTENTS

Useful Pump Formulas	2
Full Hydraulic Range Curves	3
3500 RPM Pump Curves.....	4-5
1750 RPM Pump Curves.....	6-19
1150 RPM Pump Curves.....	20-33

USEFUL PUMP FORMULAS

$$\text{Pressure (PSI)} = \frac{\text{Head (feet)} \times \text{Specific Gravity}}{2.31}$$

$$\text{Horsepower (water)} = \frac{\text{GPM} \times \text{Head (feet)} \times \text{Specific Gravity}}{3960}$$

$$\text{Head (feet)} = \frac{\text{Pressure (PSI)} \times 2.31}{\text{Specific Gravity}}$$

$$\text{Efficiency (pump)} = \frac{\text{Horsepower (water)}}{\text{Horsepower (brake)}} \times 100 \text{ per cent}$$

$$\text{Vacuum (in. of mercury)} = \frac{\text{Dynamic Suction Lift (feet)} \times .883}{\text{Specific Gravity}}$$

$$\text{NPSH (available)} = \text{Positive Factors} - \text{Negative Factors}$$

$$\text{Horsepower (brake)} = \frac{\text{GPM} \times \text{Head (feet)} \times \text{Specific Gravity}}{3960 \times \text{Pump Efficiency}}$$

AFFINITY LAWS: Effect of change of speed or impeller diameter on centrifugal pumps

	GPM Capacity	Feet Head	BHP
Impeller Diameter Change	$Q_2 = \frac{D_2}{D_1} Q_1$	$H_2 = \left(\frac{D_2}{D_1}\right)^2 H_1$	$P_2 = \left(\frac{D_2}{D_1}\right)^3 P_1$
Speed Change	$Q_2 = \frac{\text{RPM}_2}{\text{RPM}_1} Q_1$	$H_2 = \left(\frac{\text{RPM}_2}{\text{RPM}_1}\right)^2 H_1$	$P_2 = \left(\frac{\text{RPM}_2}{\text{RPM}_1}\right)^3 P_1$

Where Q = GPM, H = Head, P = BHP, D = Impeller Diameter, RPM = Pump Speed

60 HZ FULL HYDRAULIC RANGE CURVES

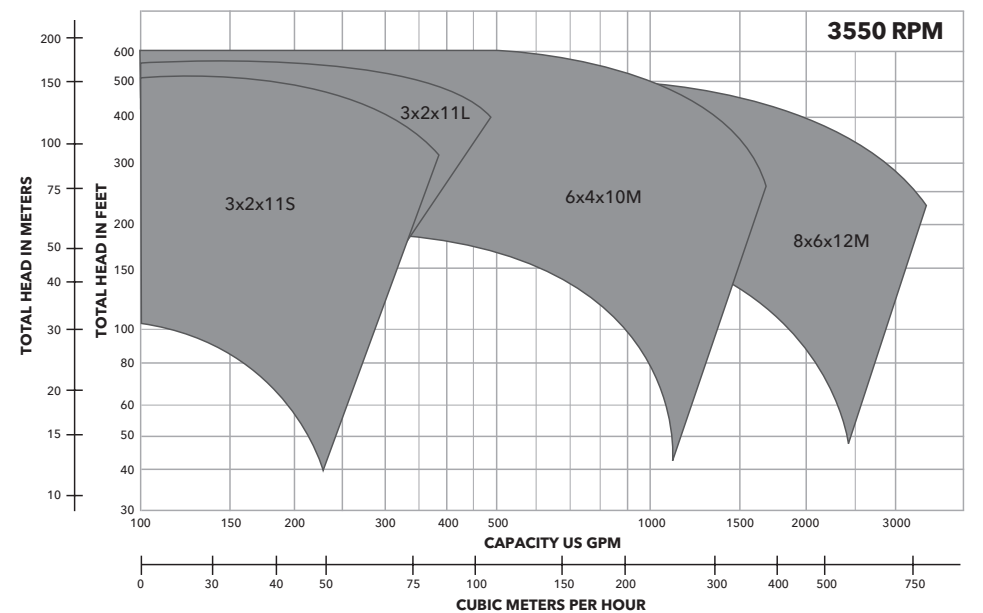
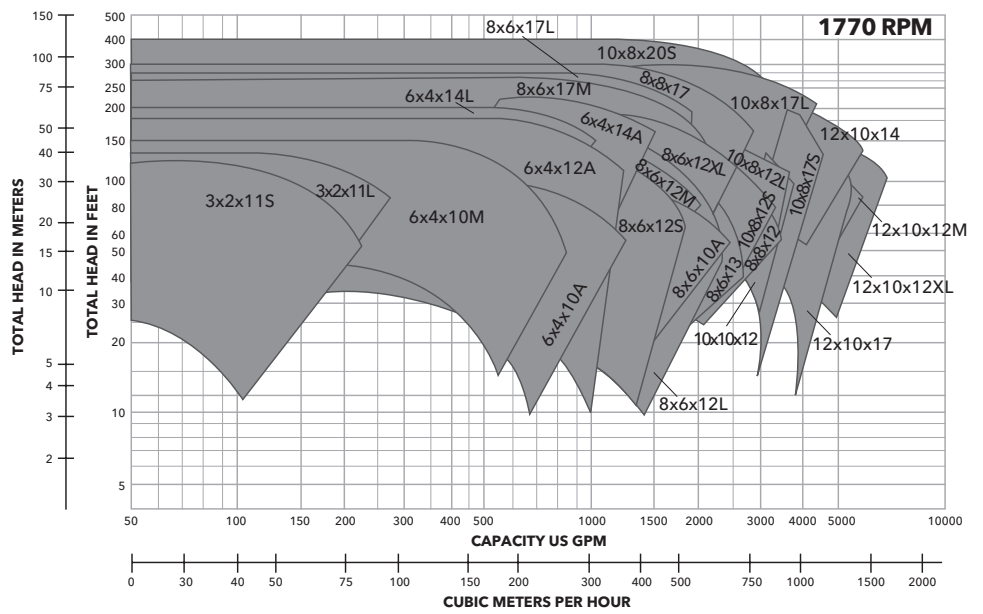
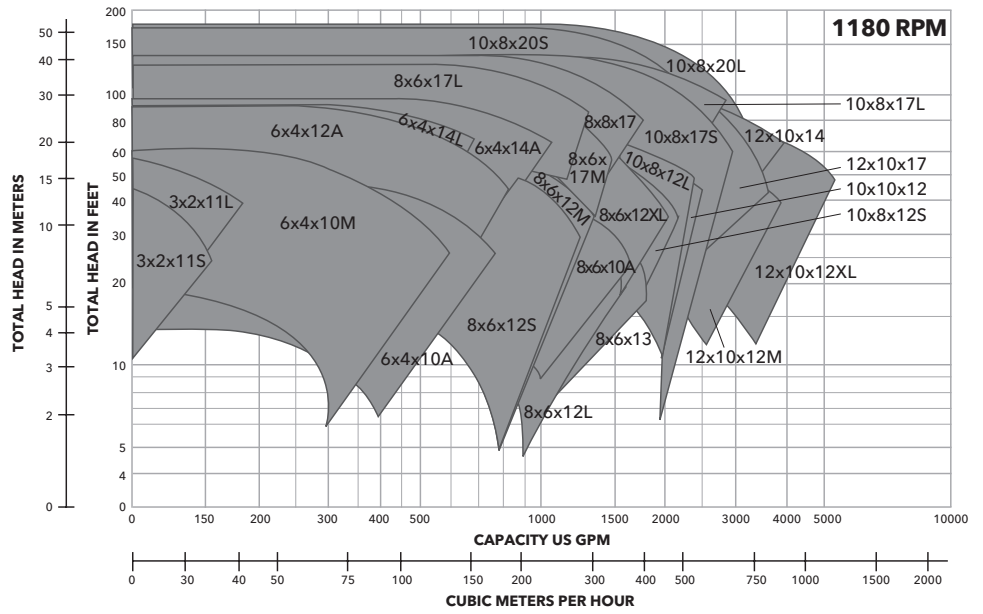

SERIES A-C 8100 - 60 Hz

3500 RPM PUMP CURVES

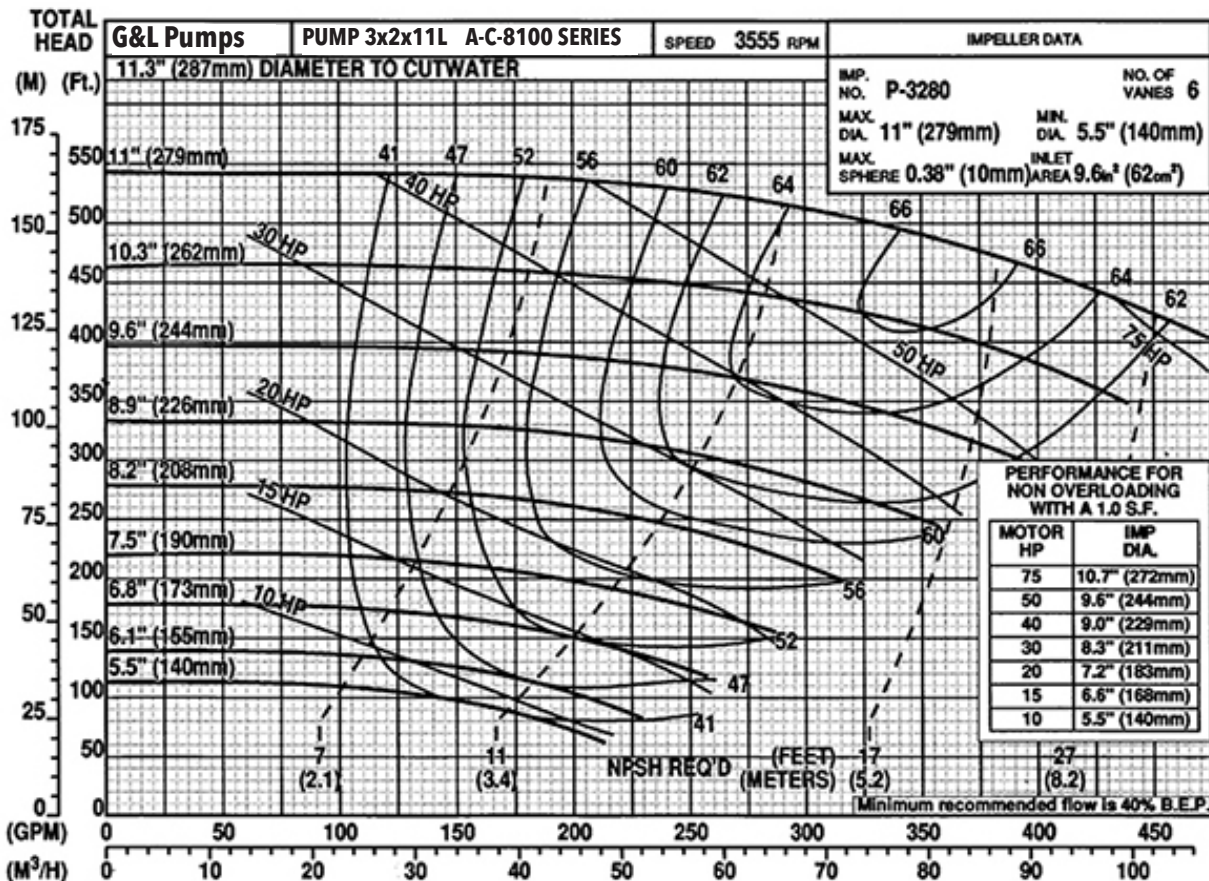
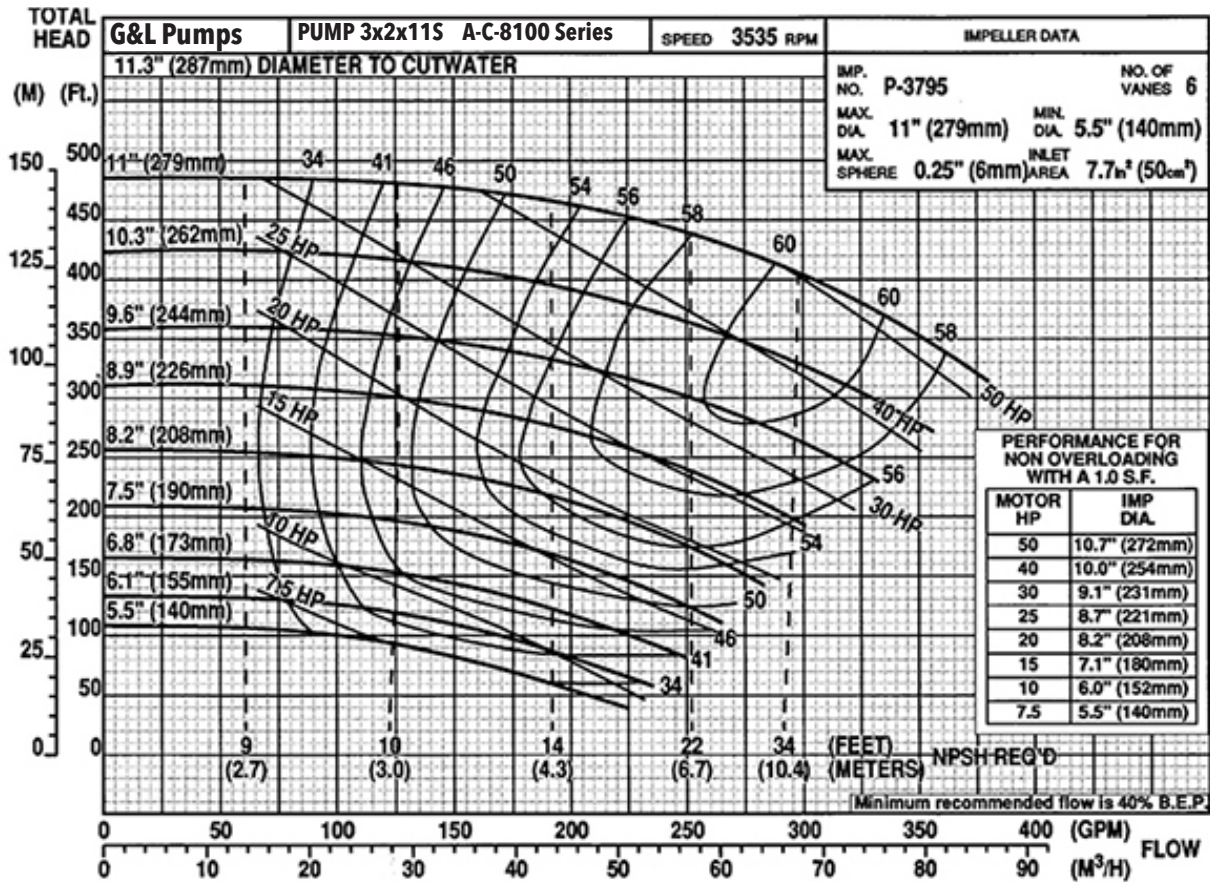

SERIES A-C 8100 - 60 Hz

3500 RPM PUMP CURVES

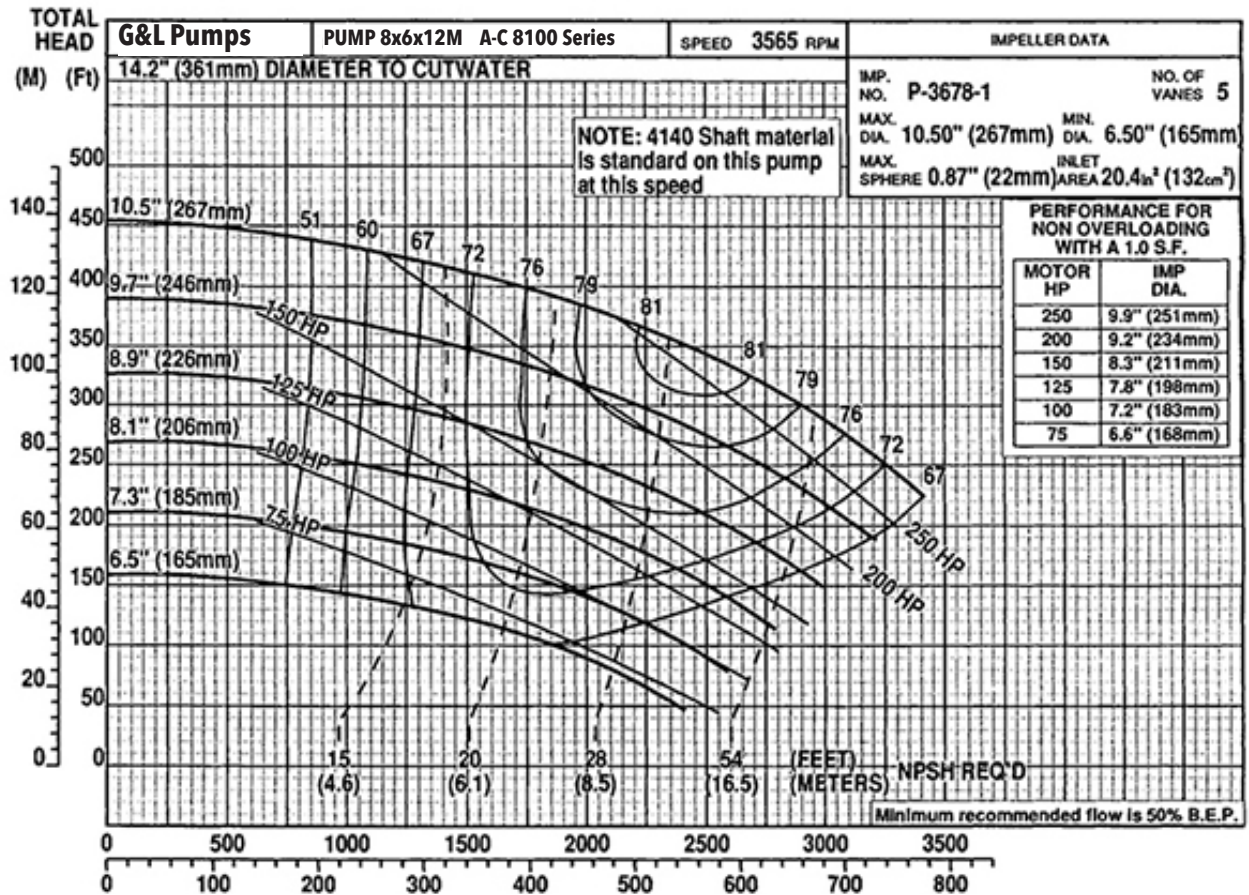
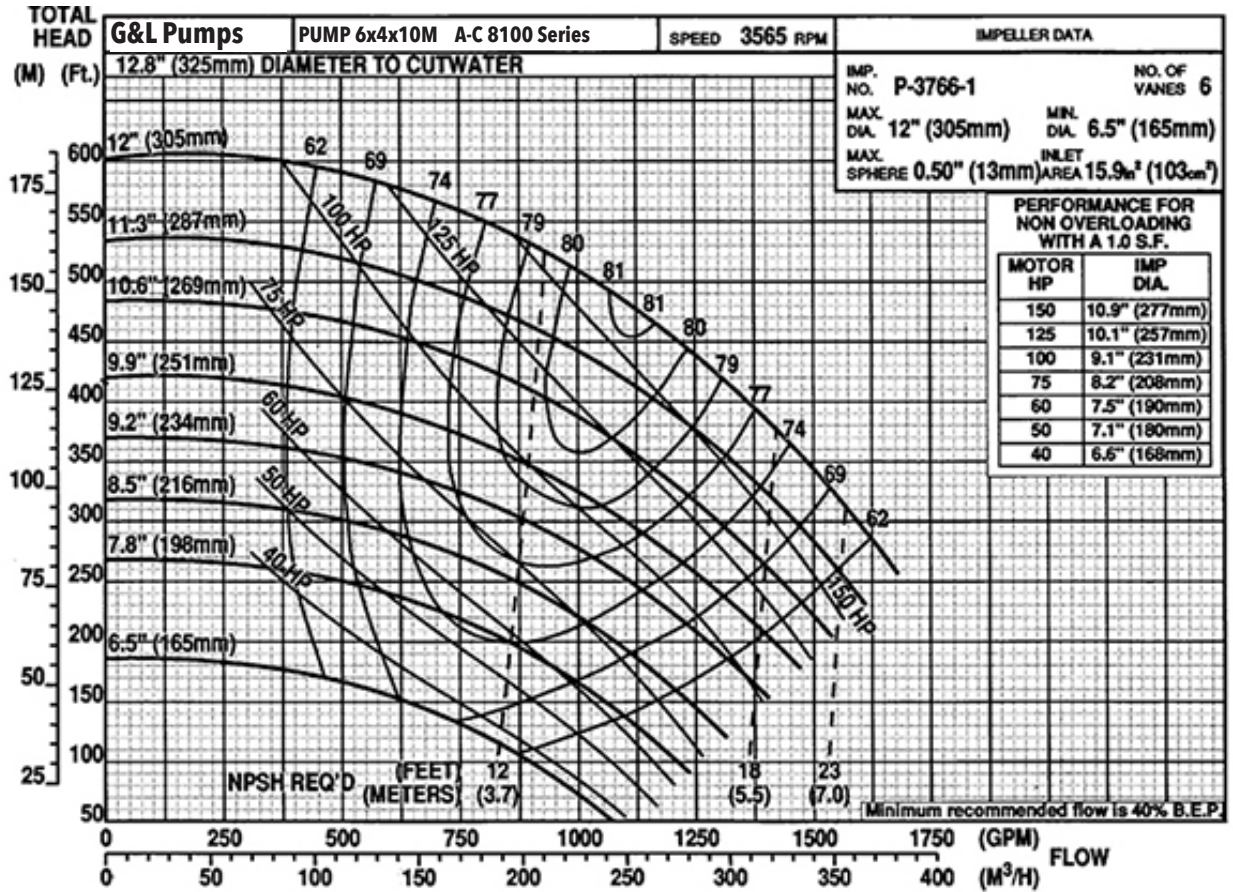

SERIES A-C 8100 - 60 Hz

1750 RPM PUMP CURVES

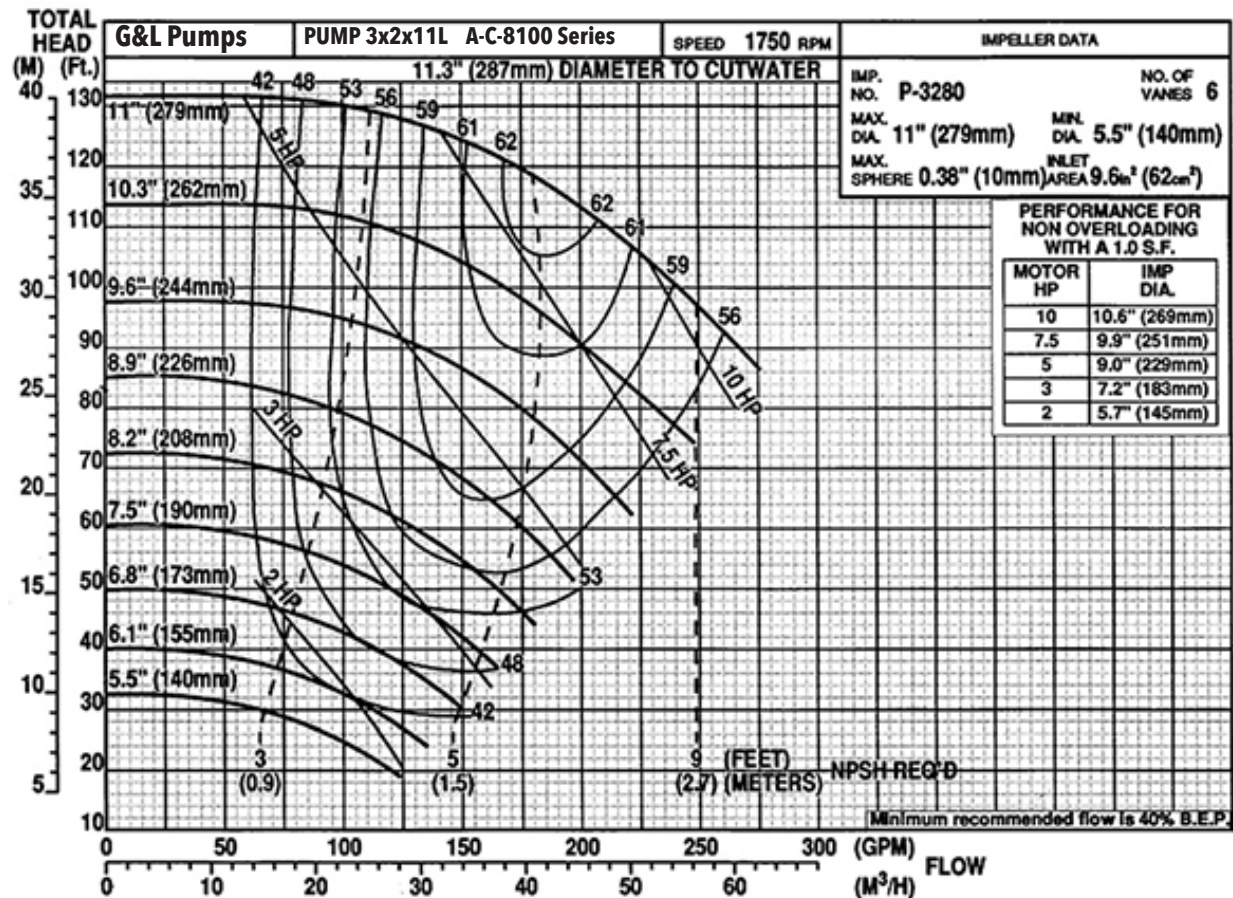
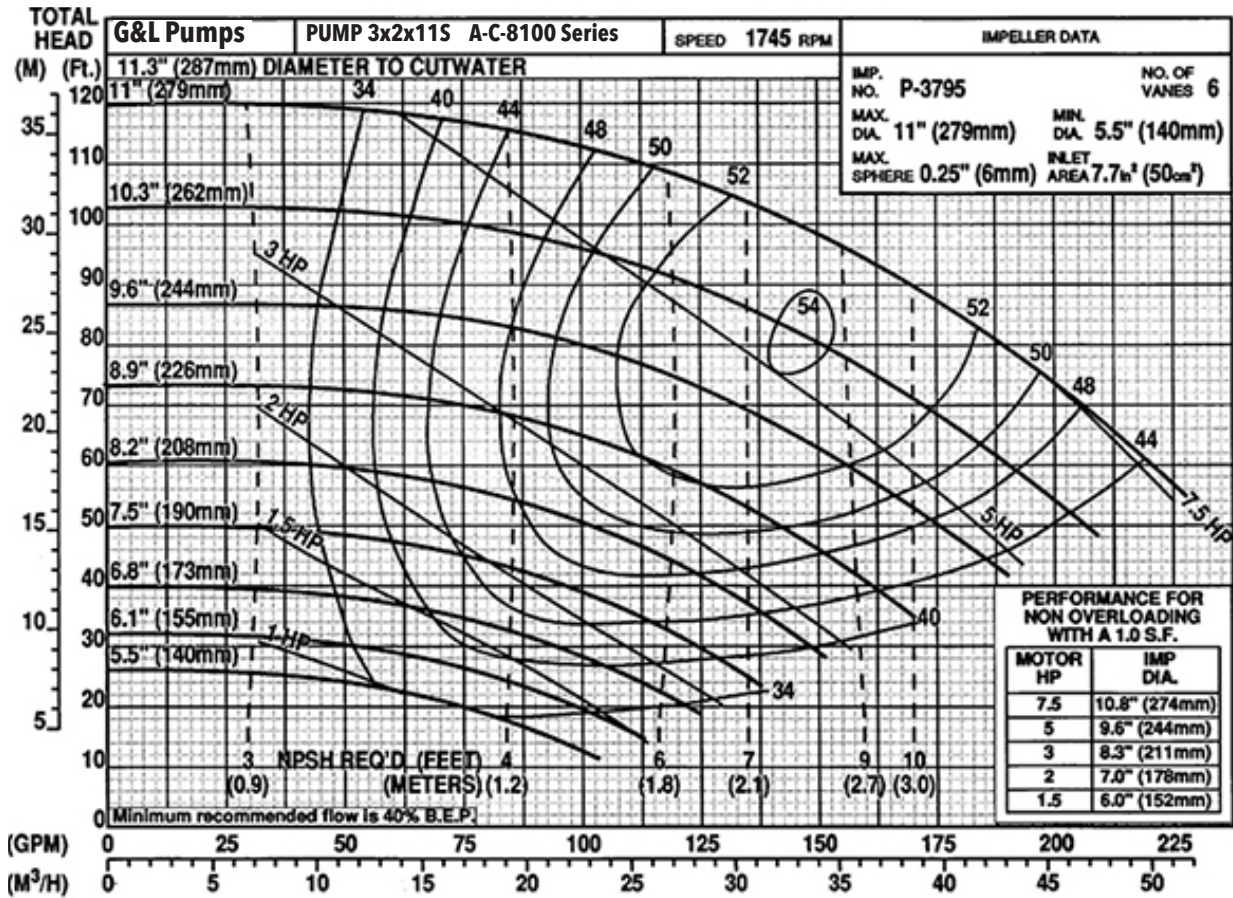

SERIES A-C 8100 - 60 Hz

1750 RPM PUMP CURVES

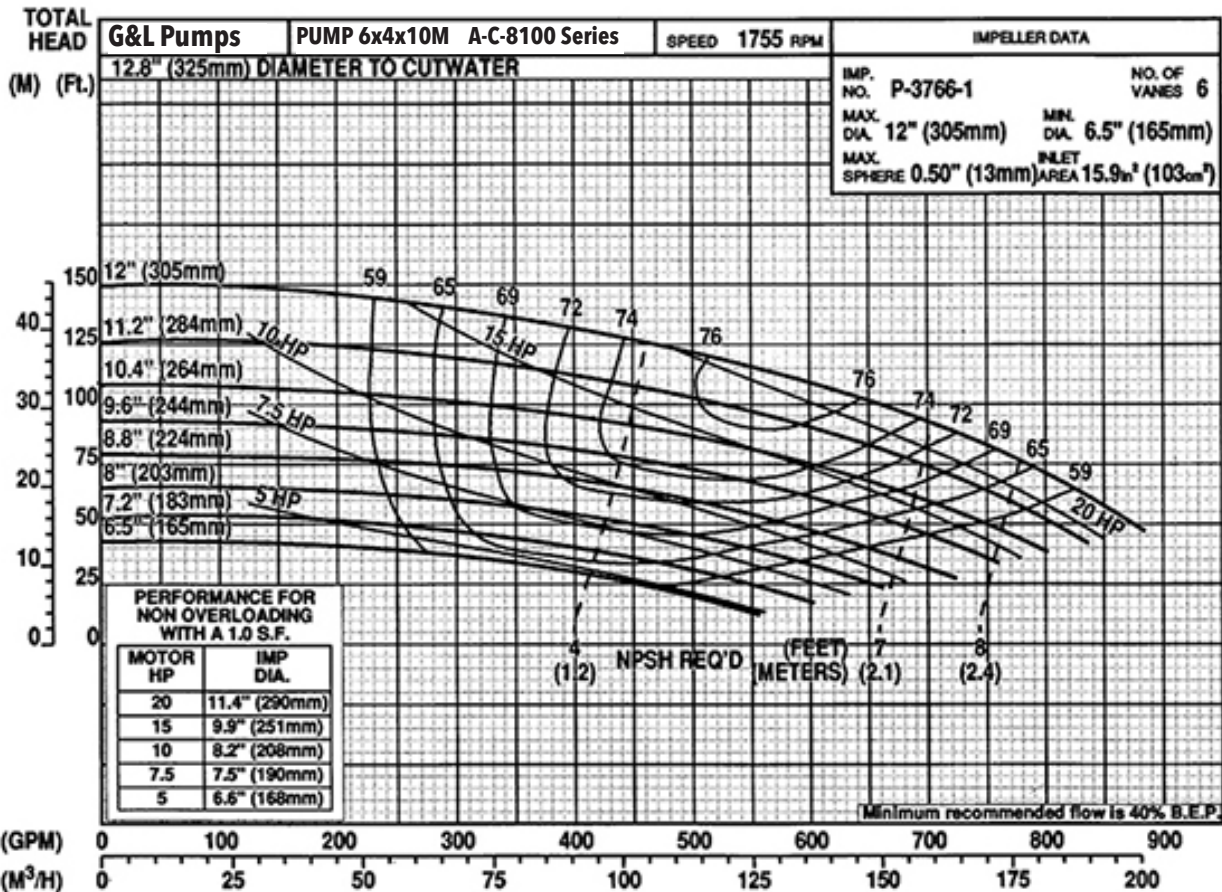
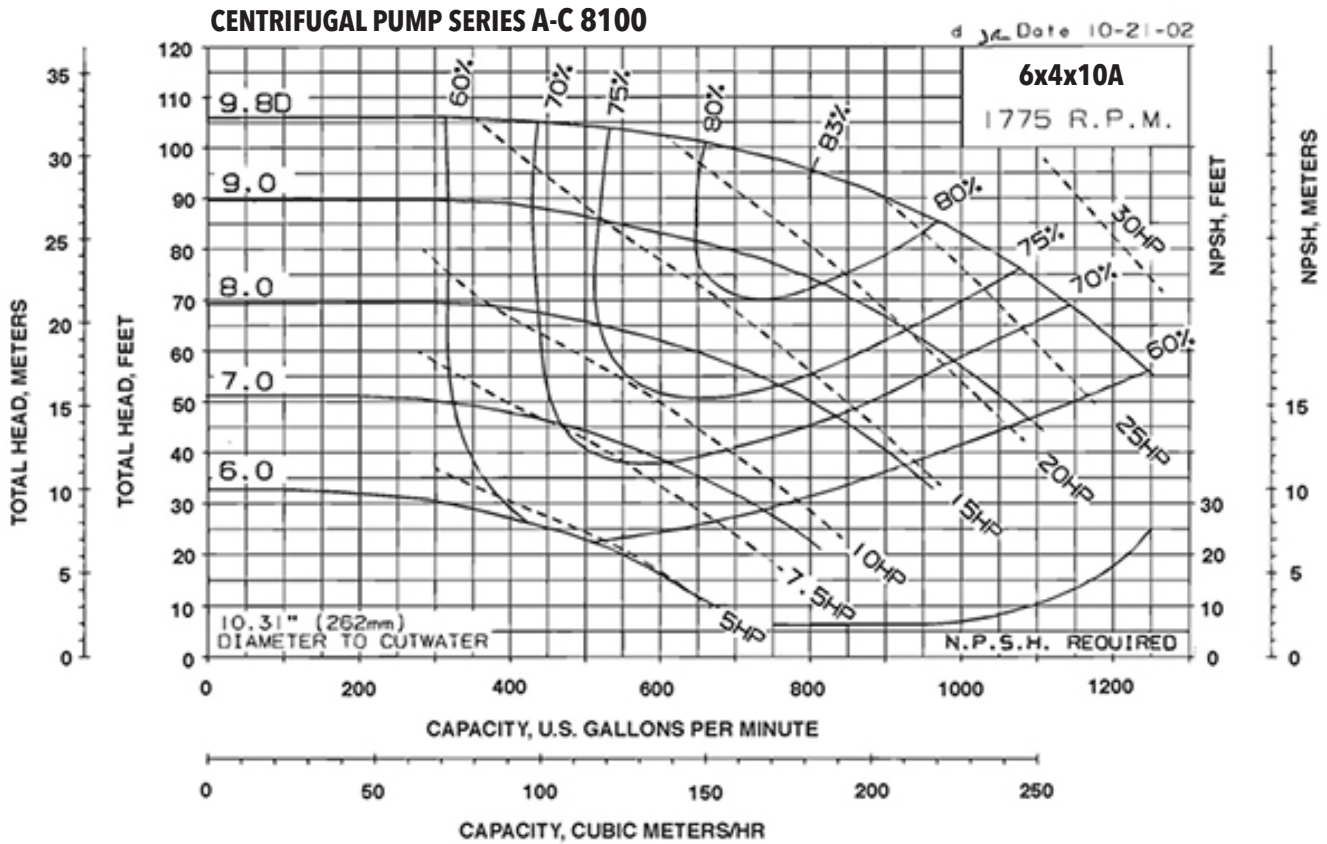

SERIES A-C 8100 - 60 Hz

1750 RPM PUMP CURVES

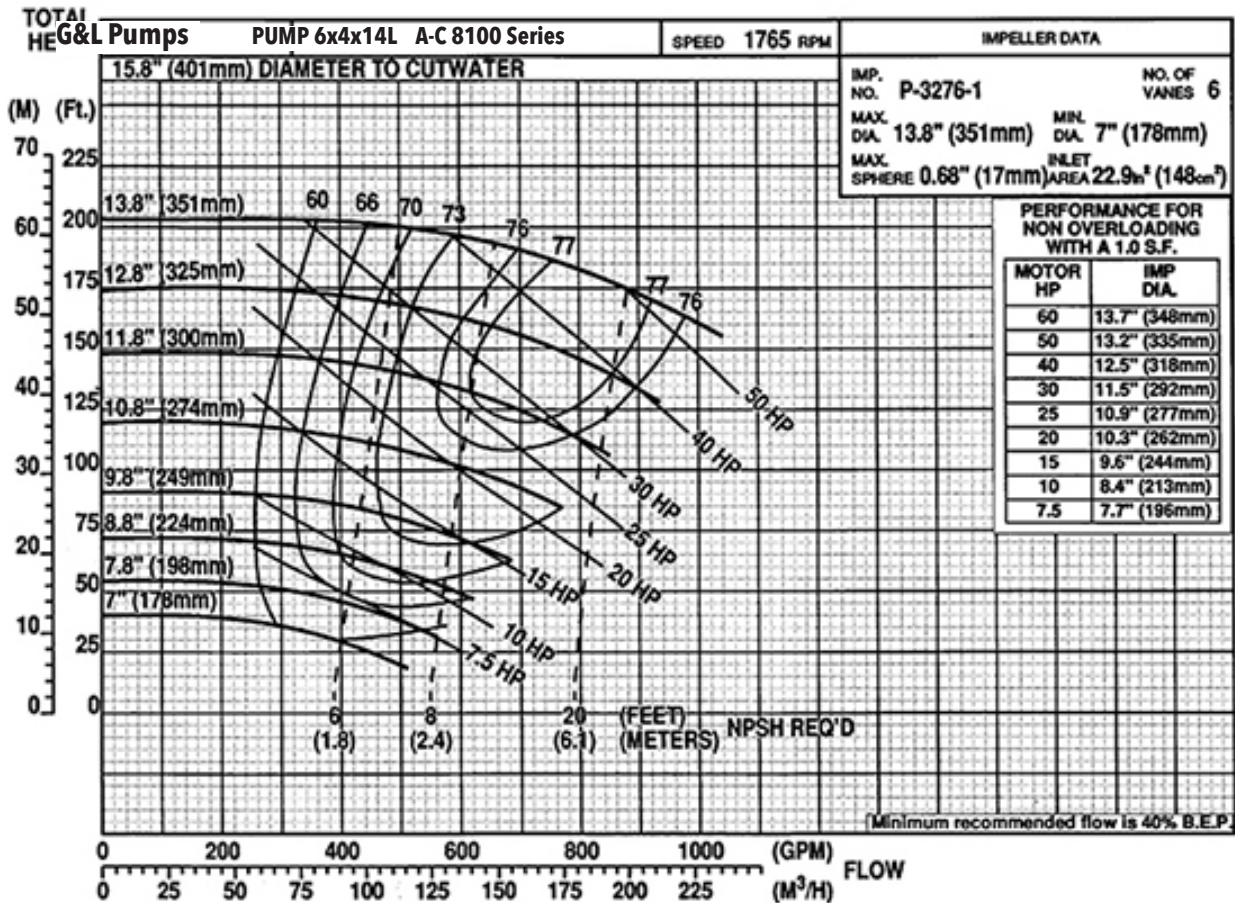
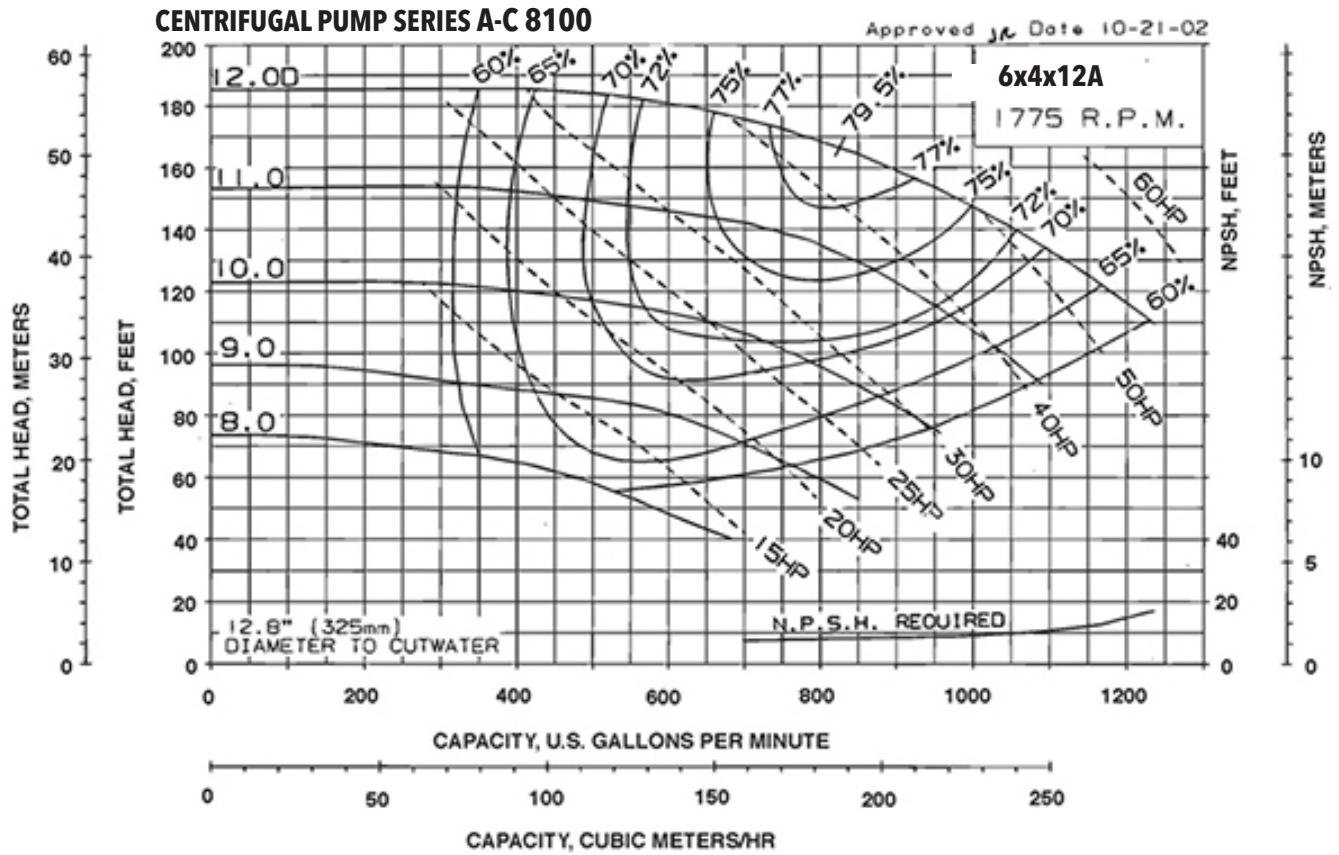

SERIES A-C 8100 - 60 Hz

1750 RPM PUMP CURVES

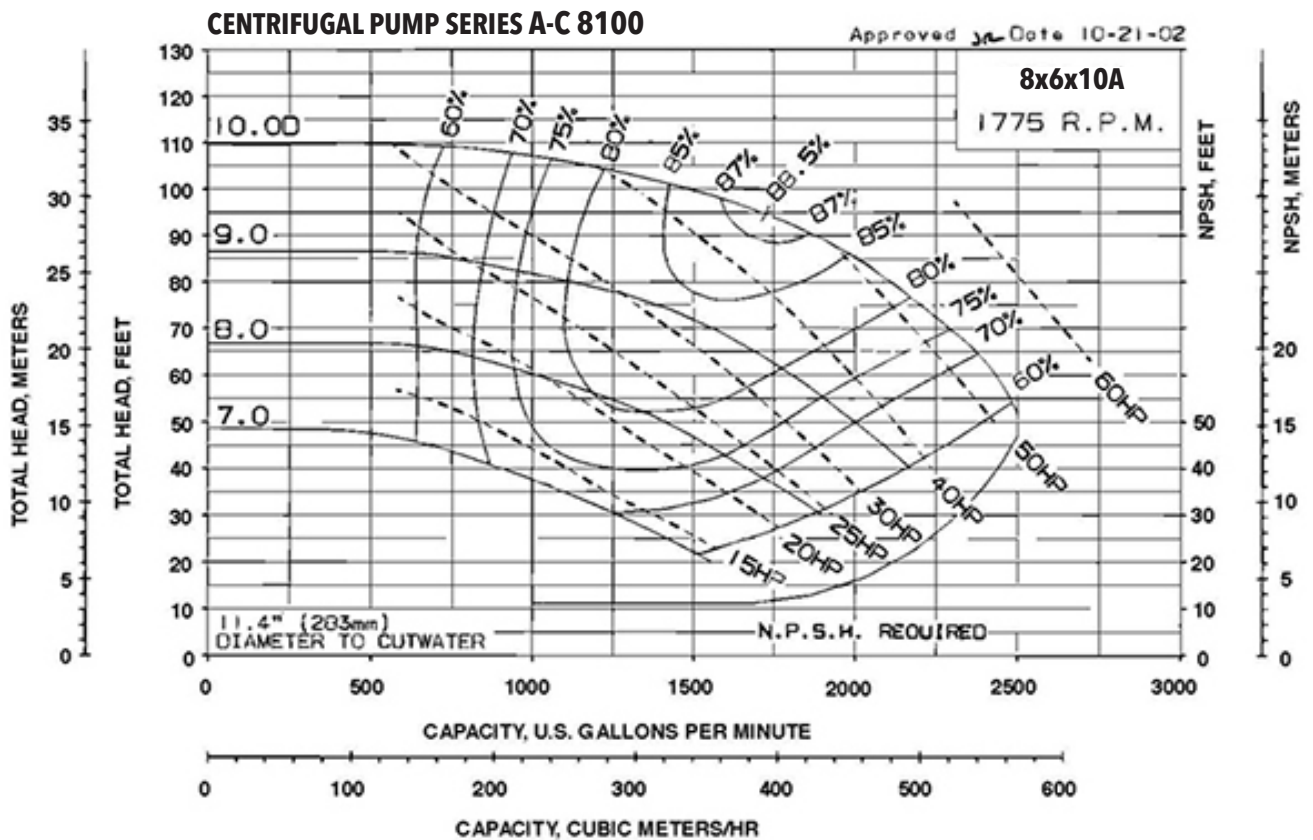
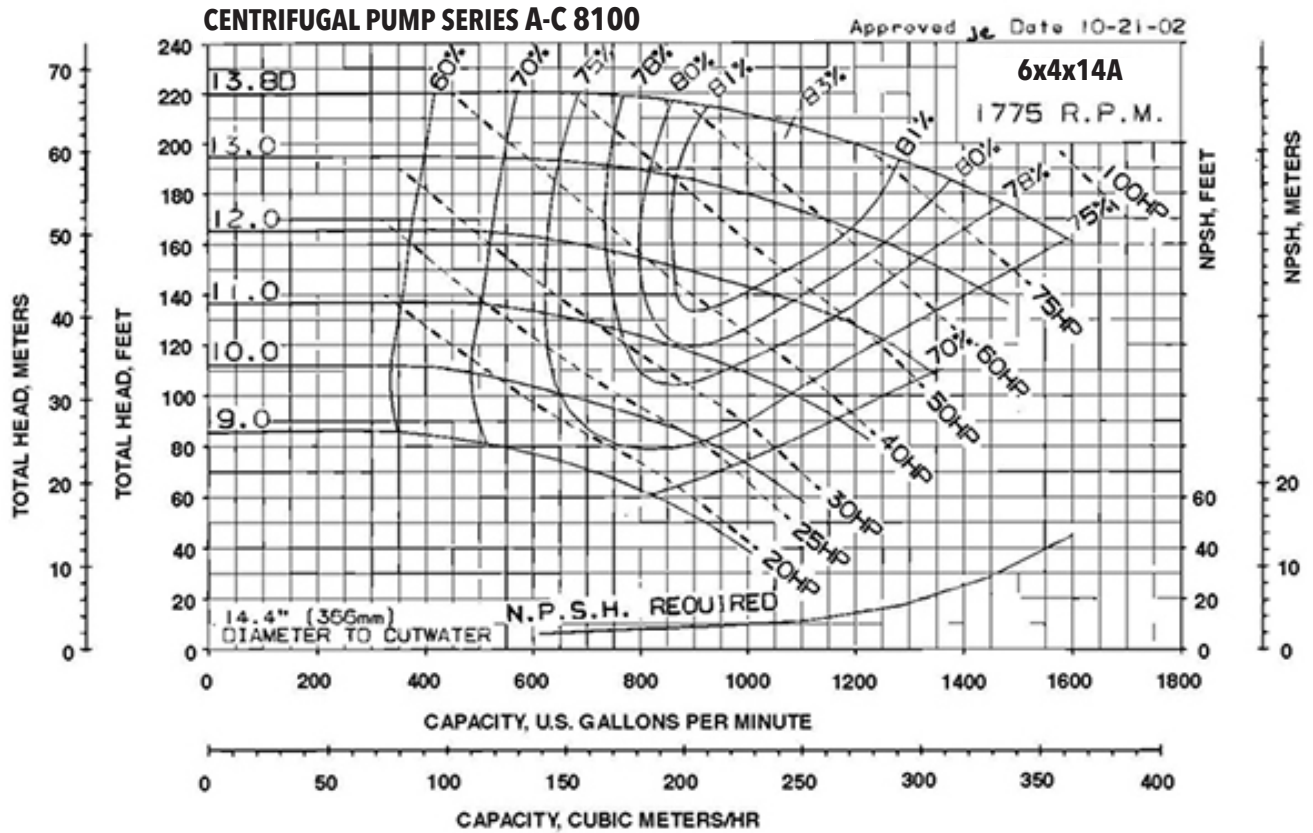

SERIES A-C 8100 - 60 Hz

1750 RPM PUMP CURVES

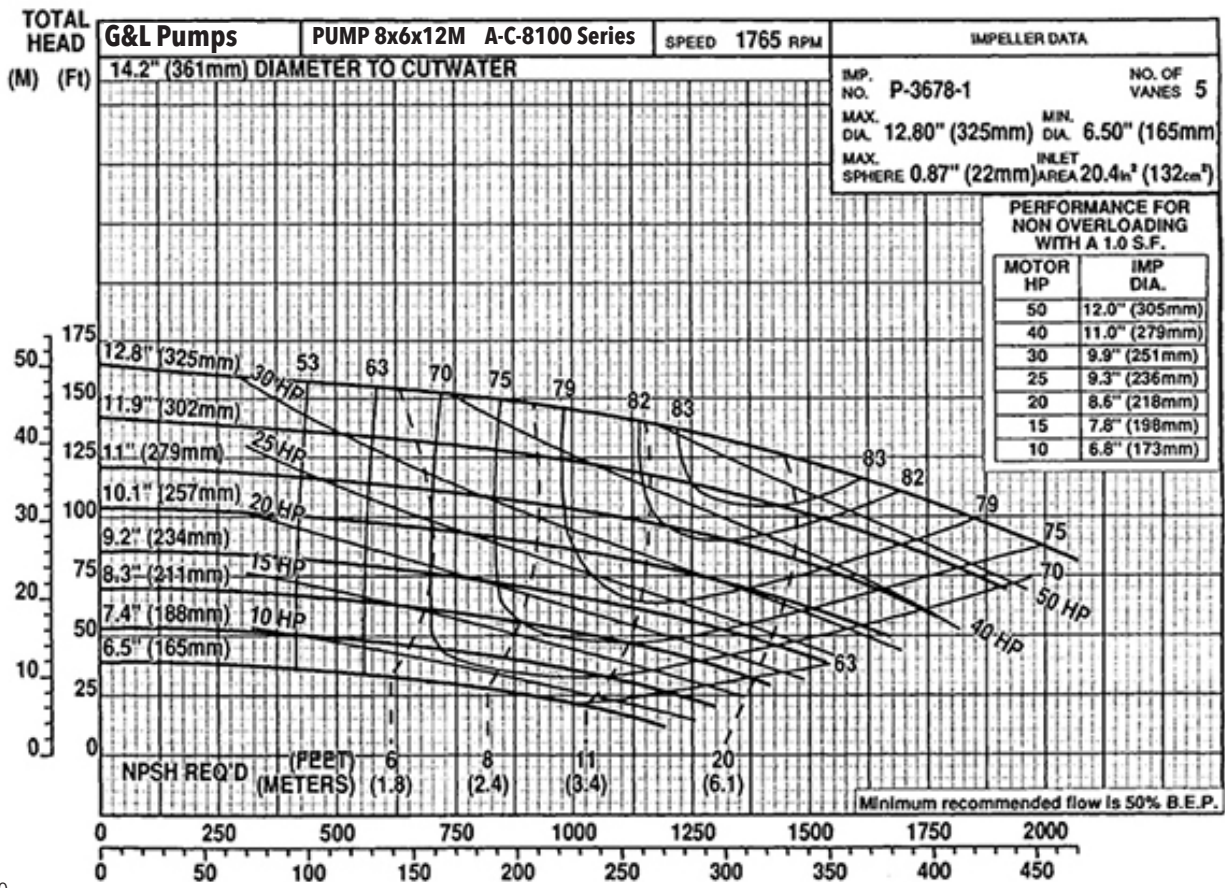
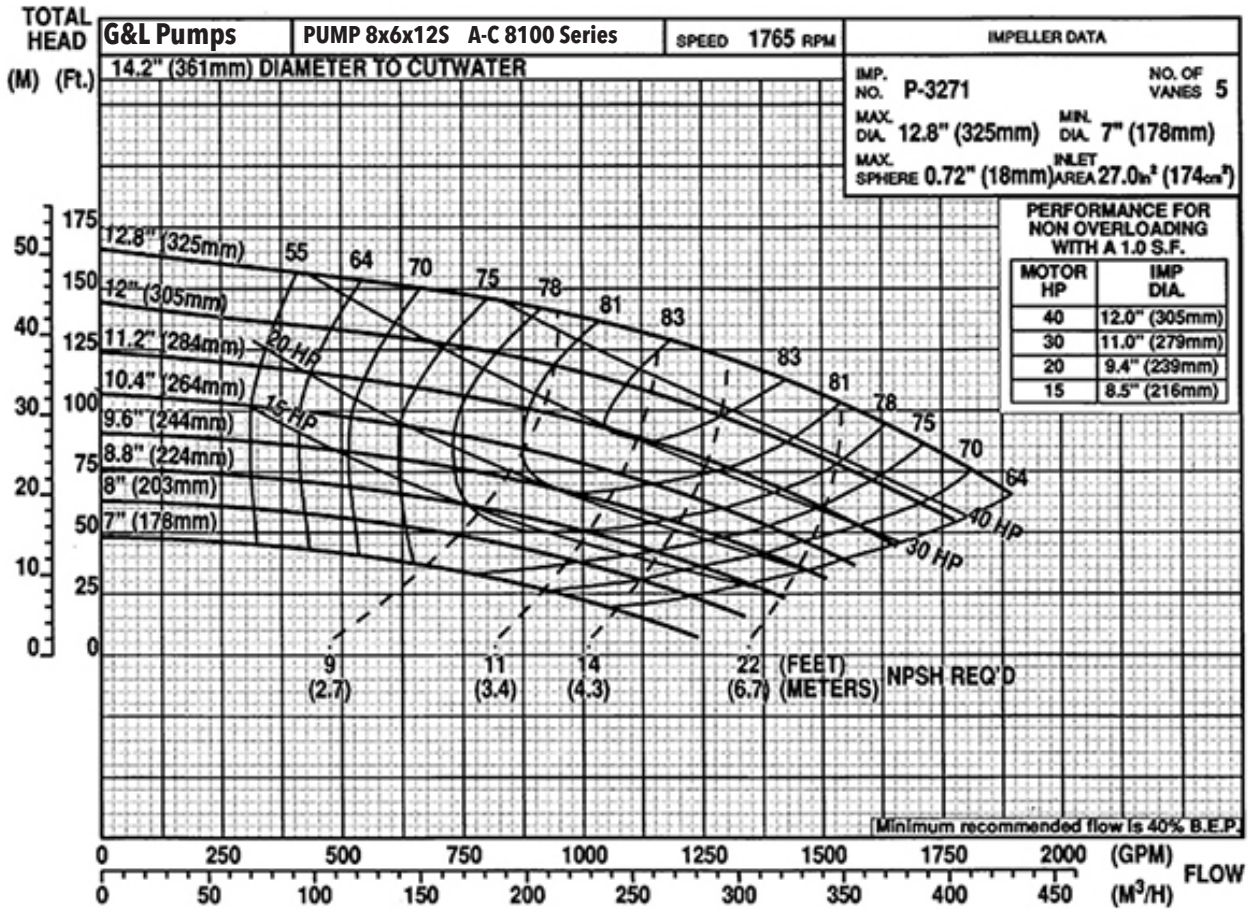

SERIES A-C 8100 - 60 Hz

1750 RPM PUMP CURVES

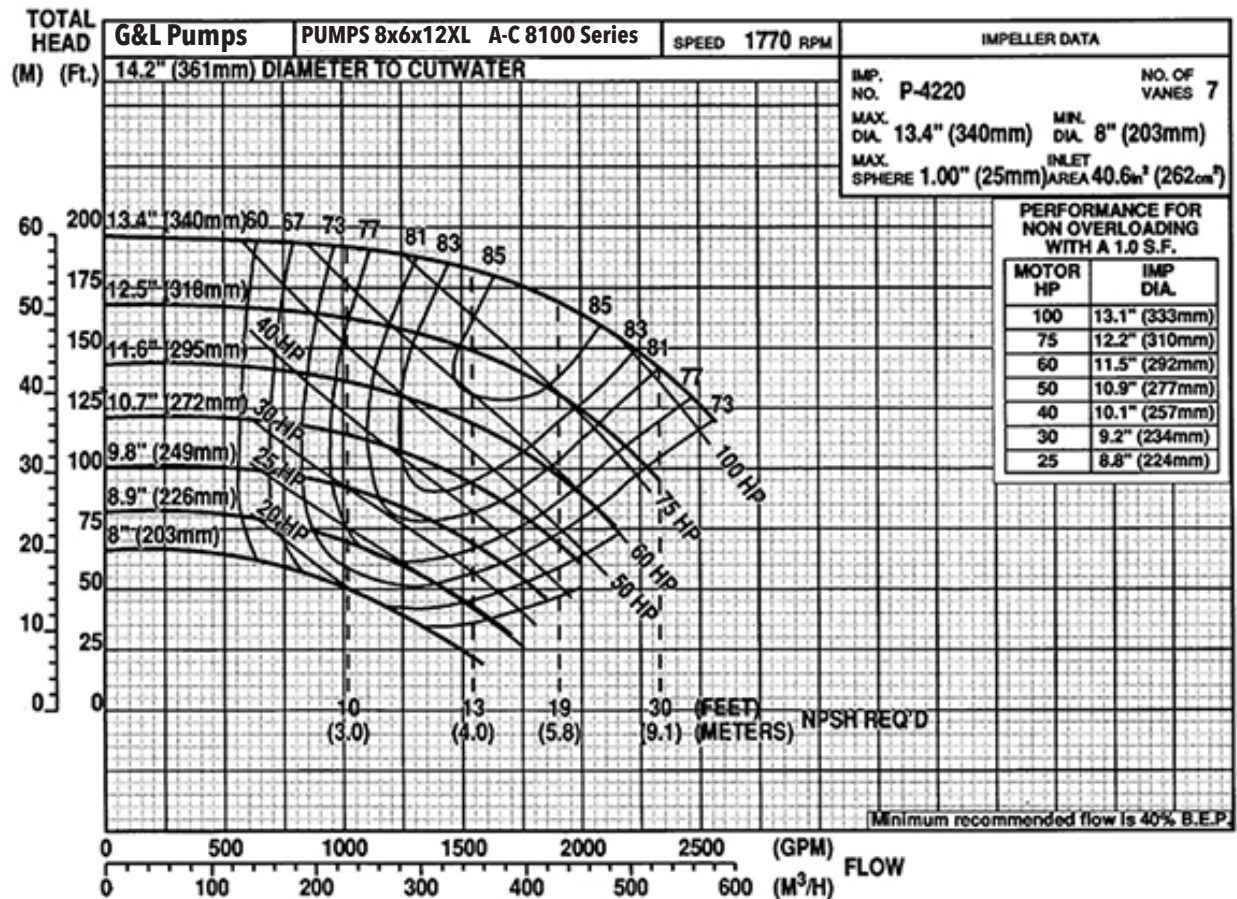
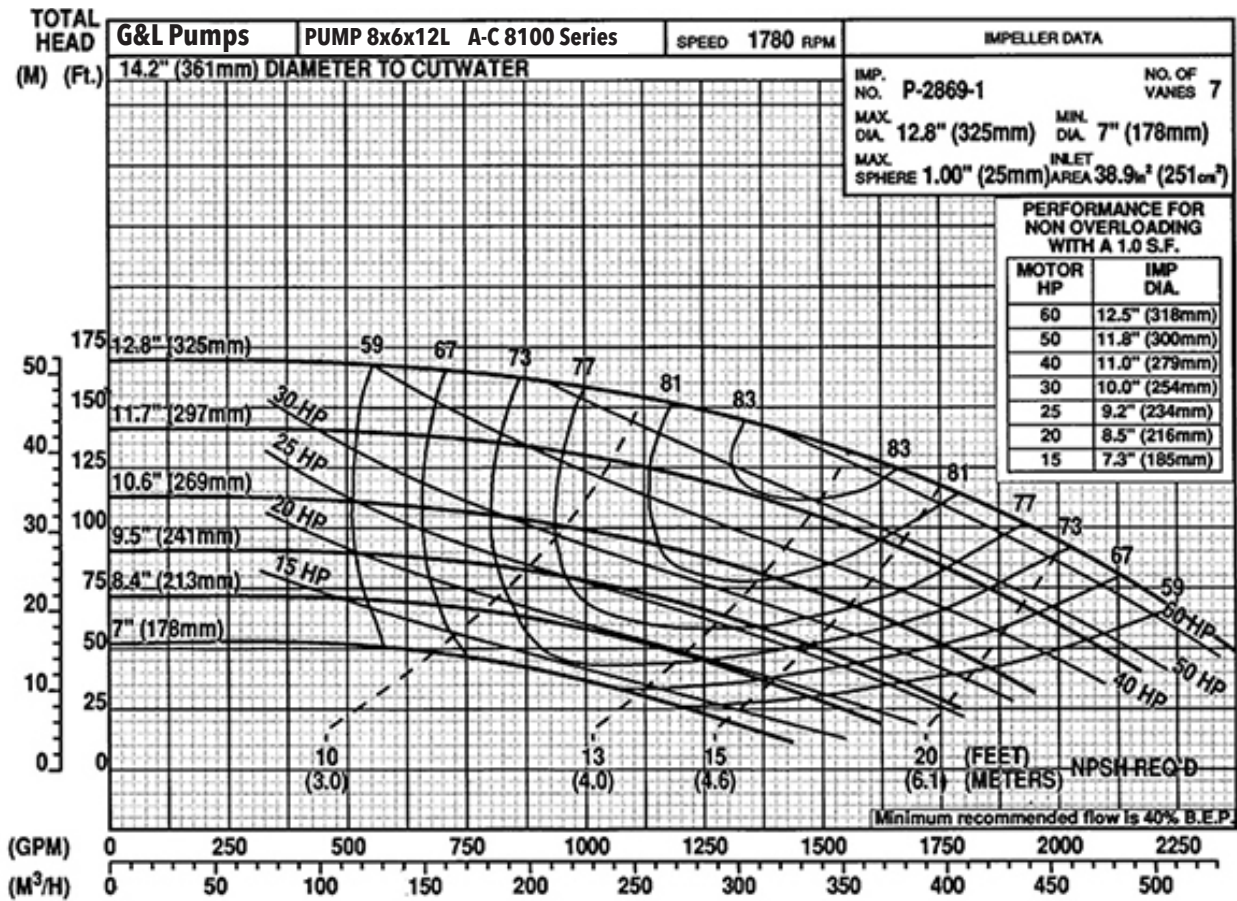

SERIES A-C 8100 - 60 Hz

1750 RPM PUMP CURVES

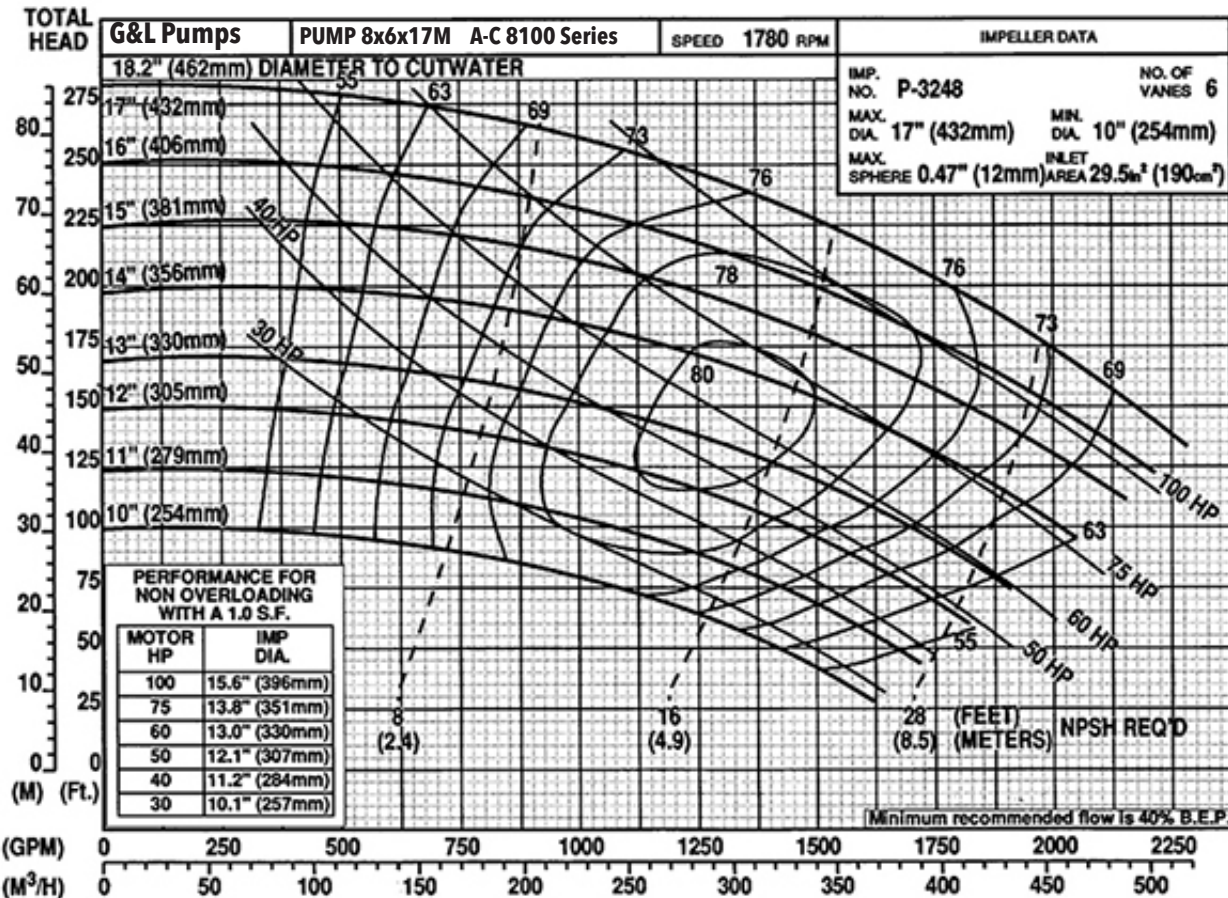
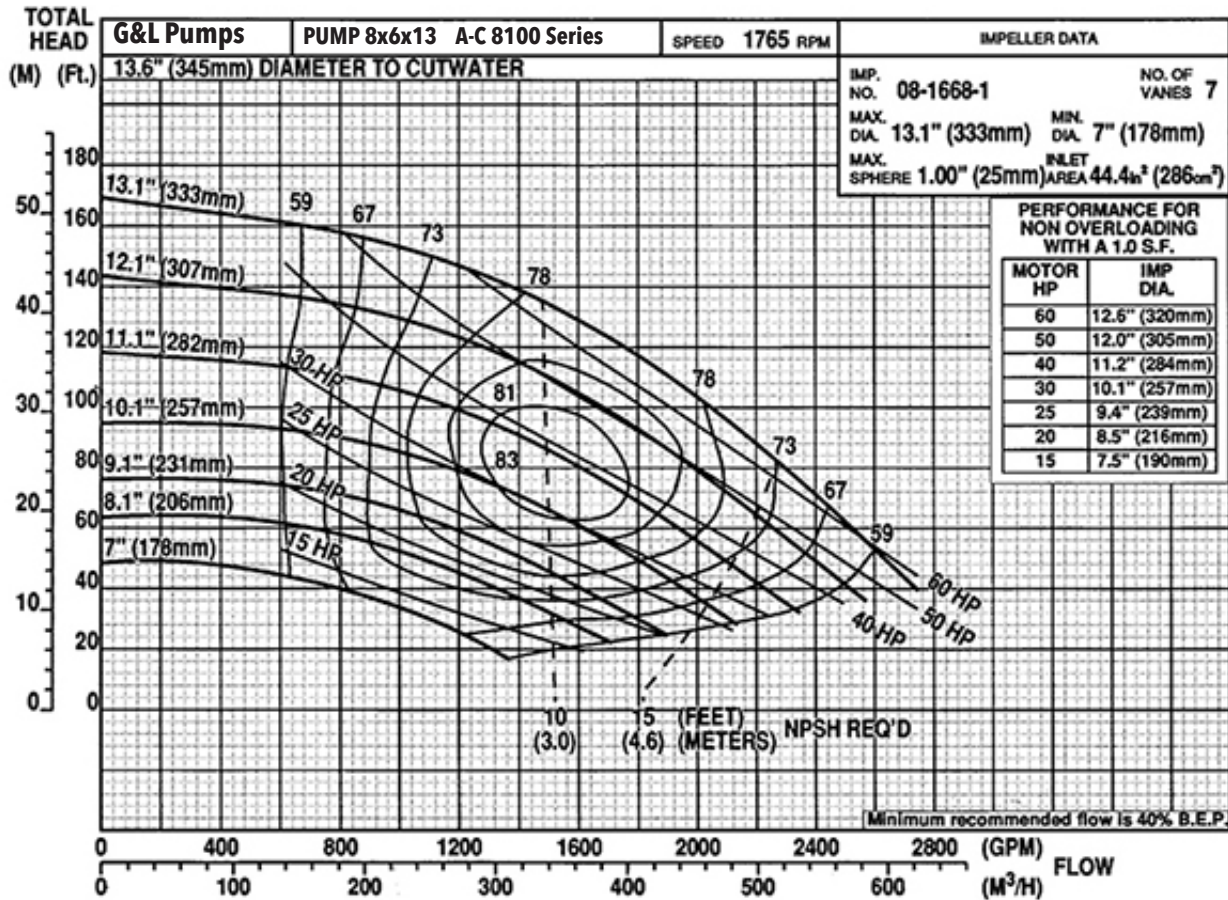

SERIES A-C 8100 - 60 Hz

1750 RPM PUMP CURVES

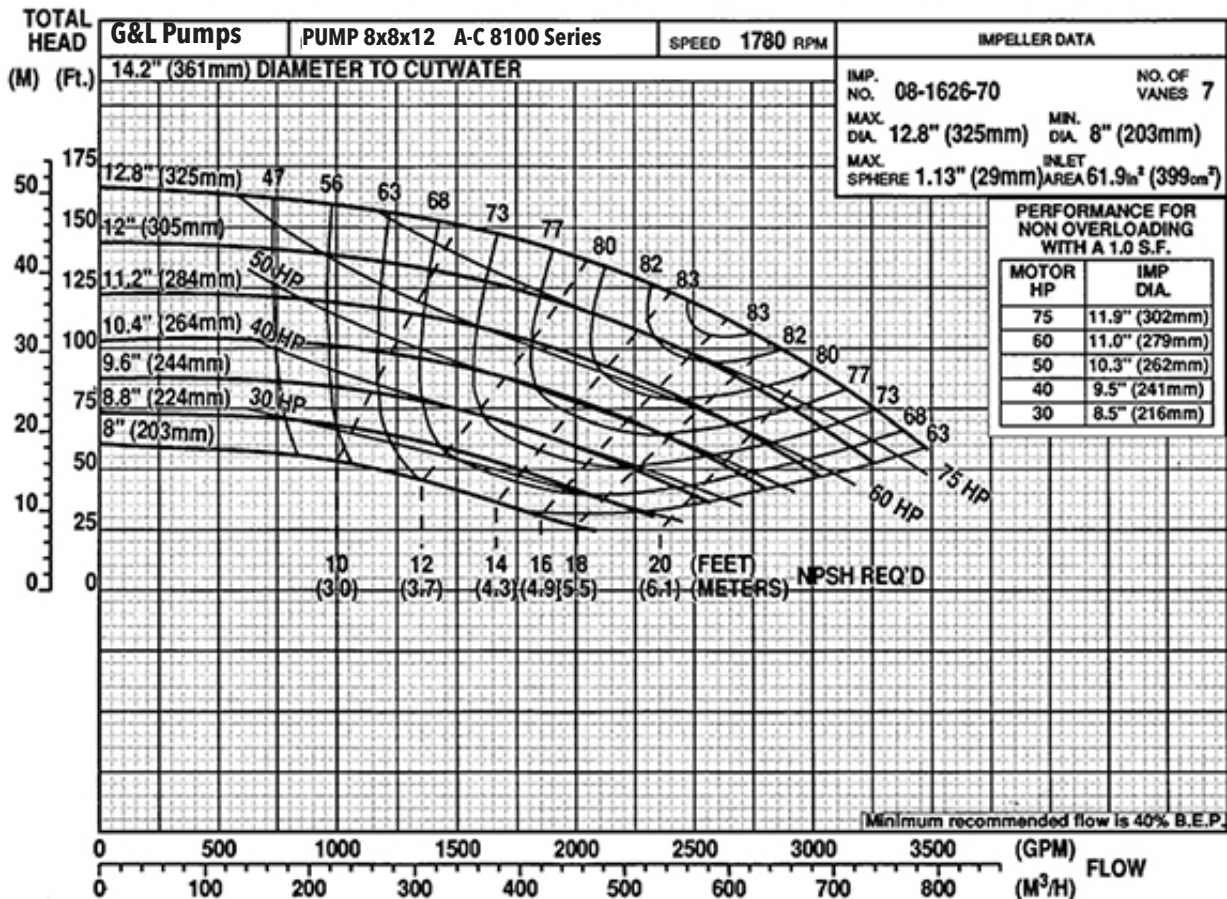
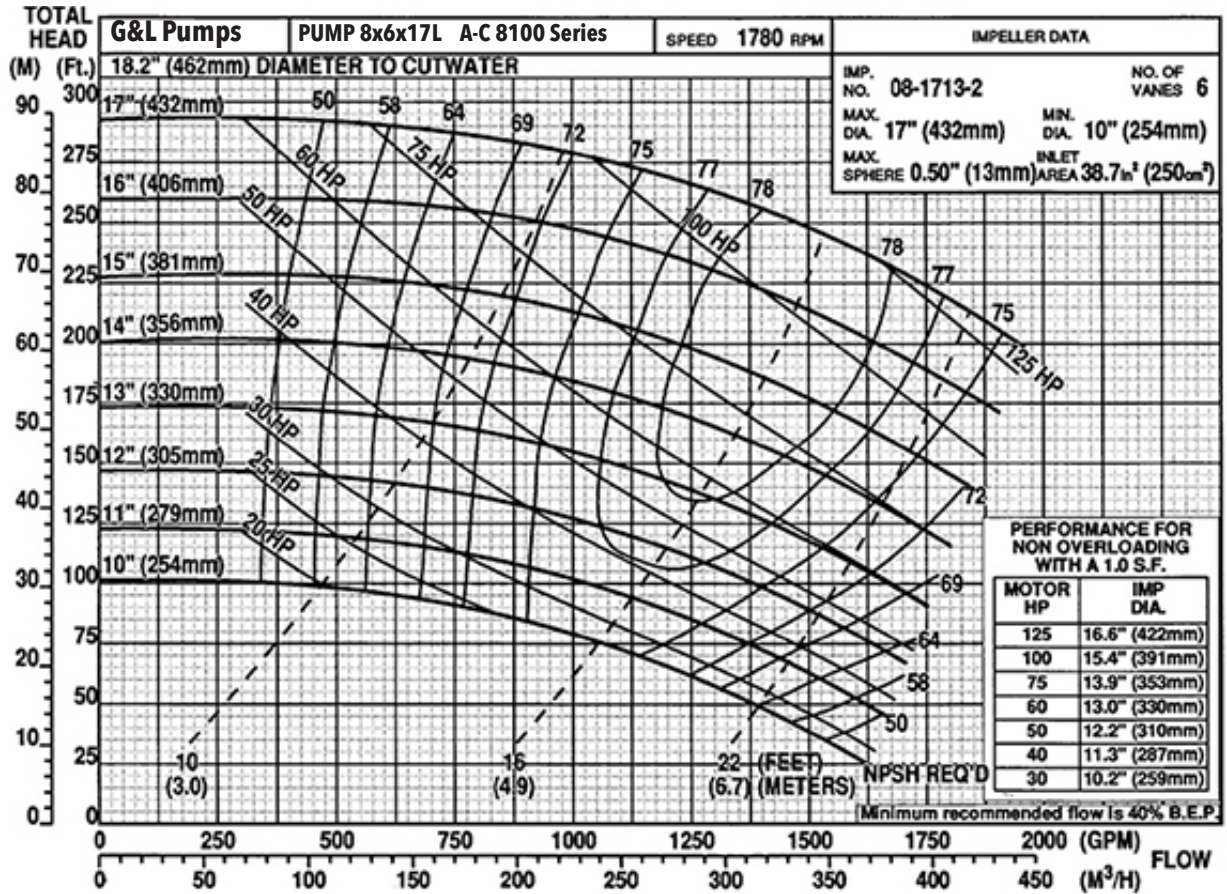

SERIES A-C 8100 - 60 Hz

1750 RPM PUMP CURVES

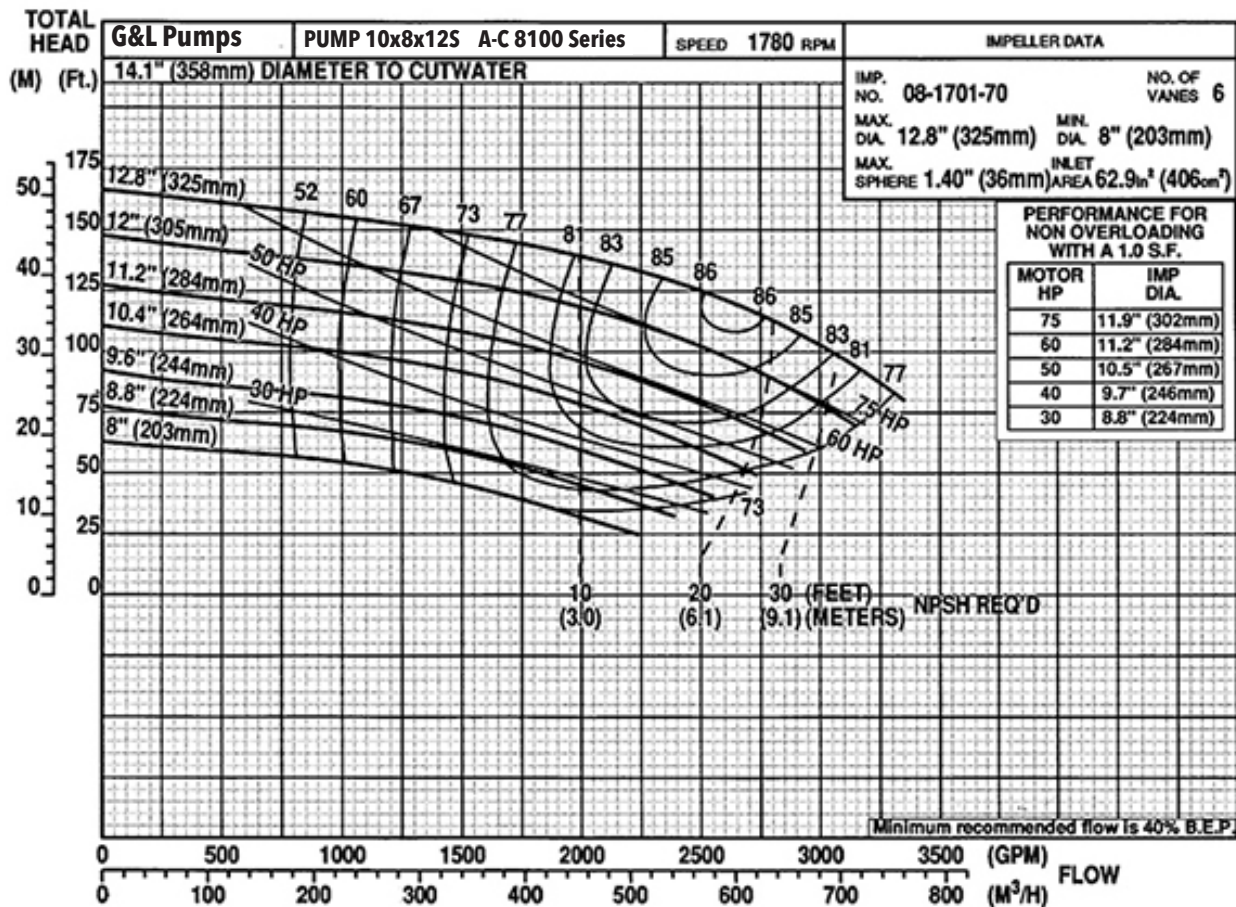
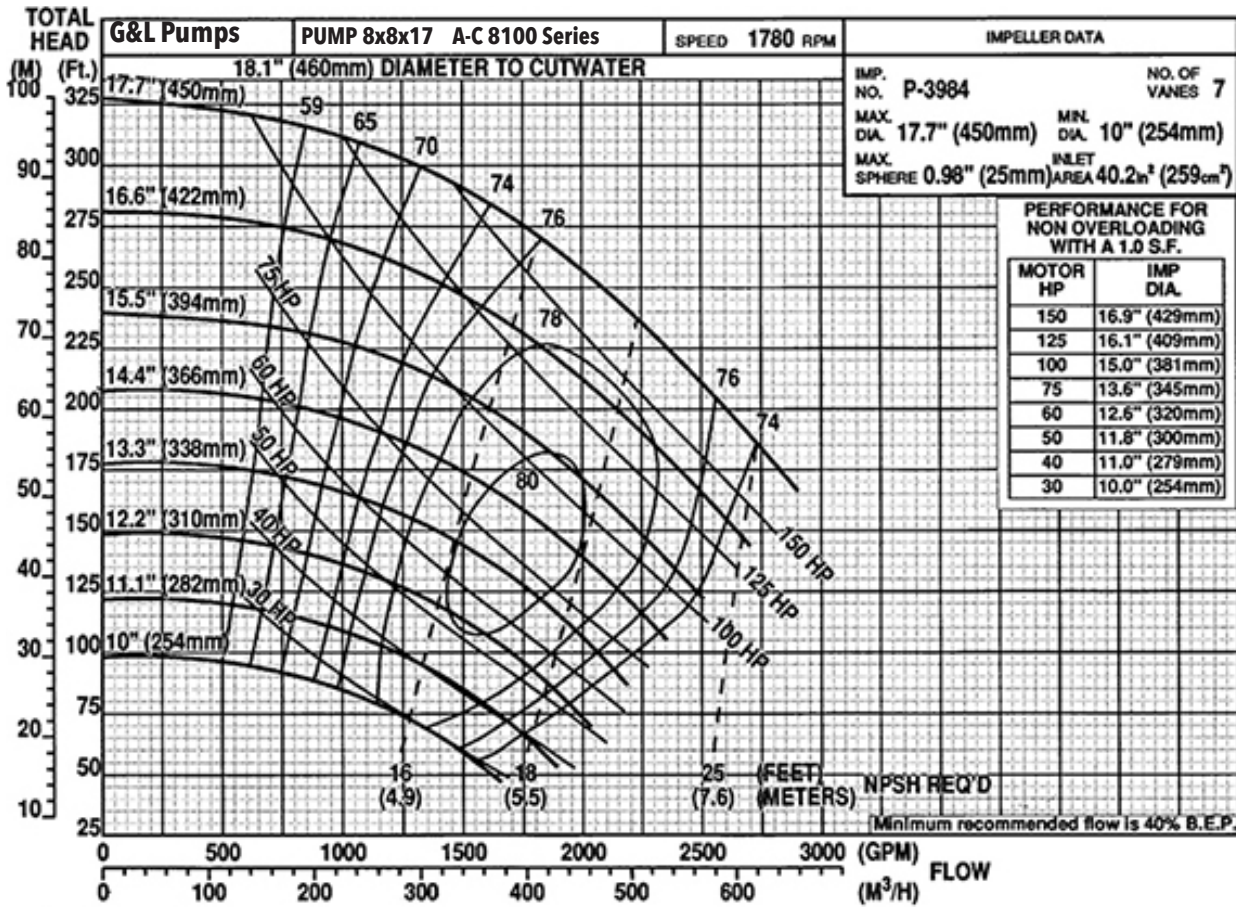

SERIES A-C 8100 - 60 Hz

1750 RPM PUMP CURVES

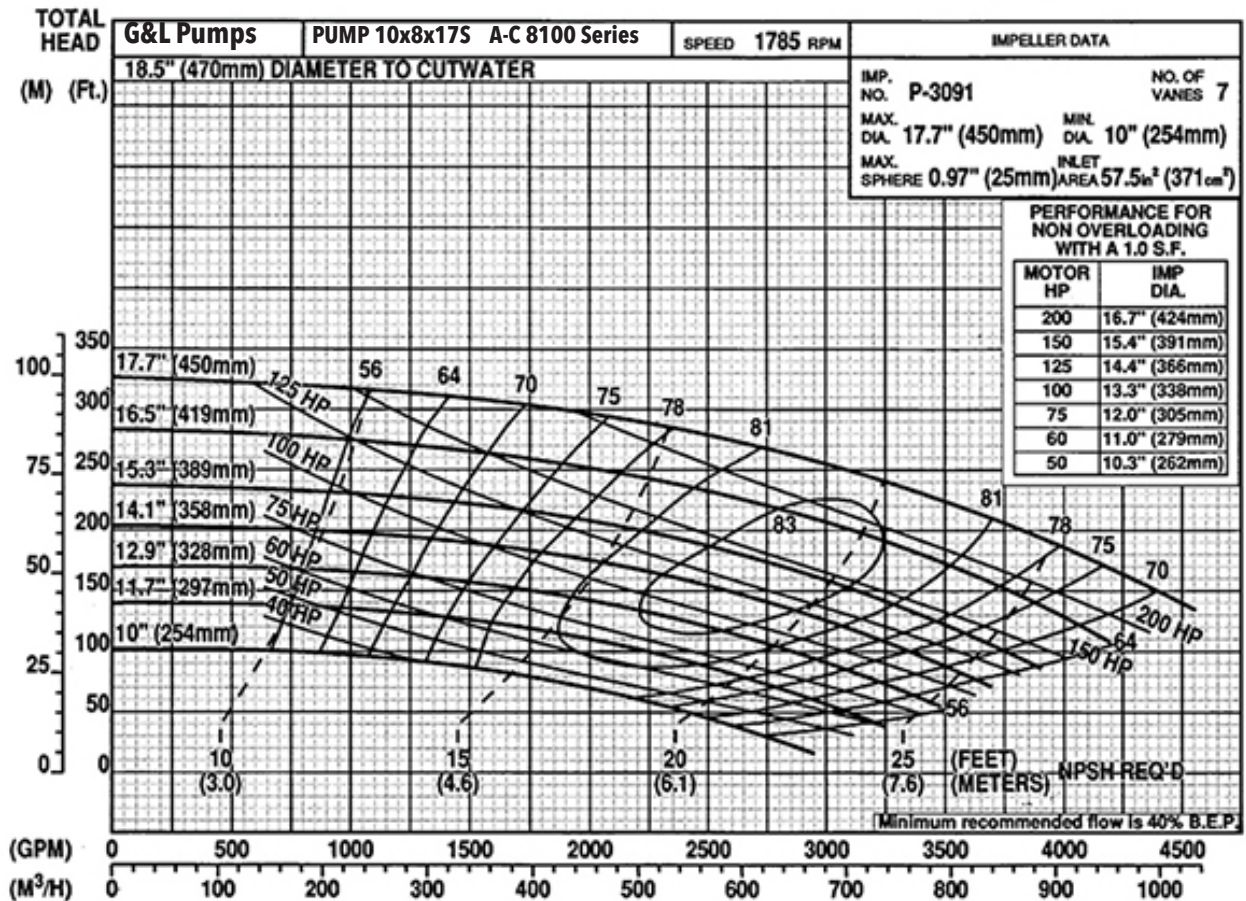
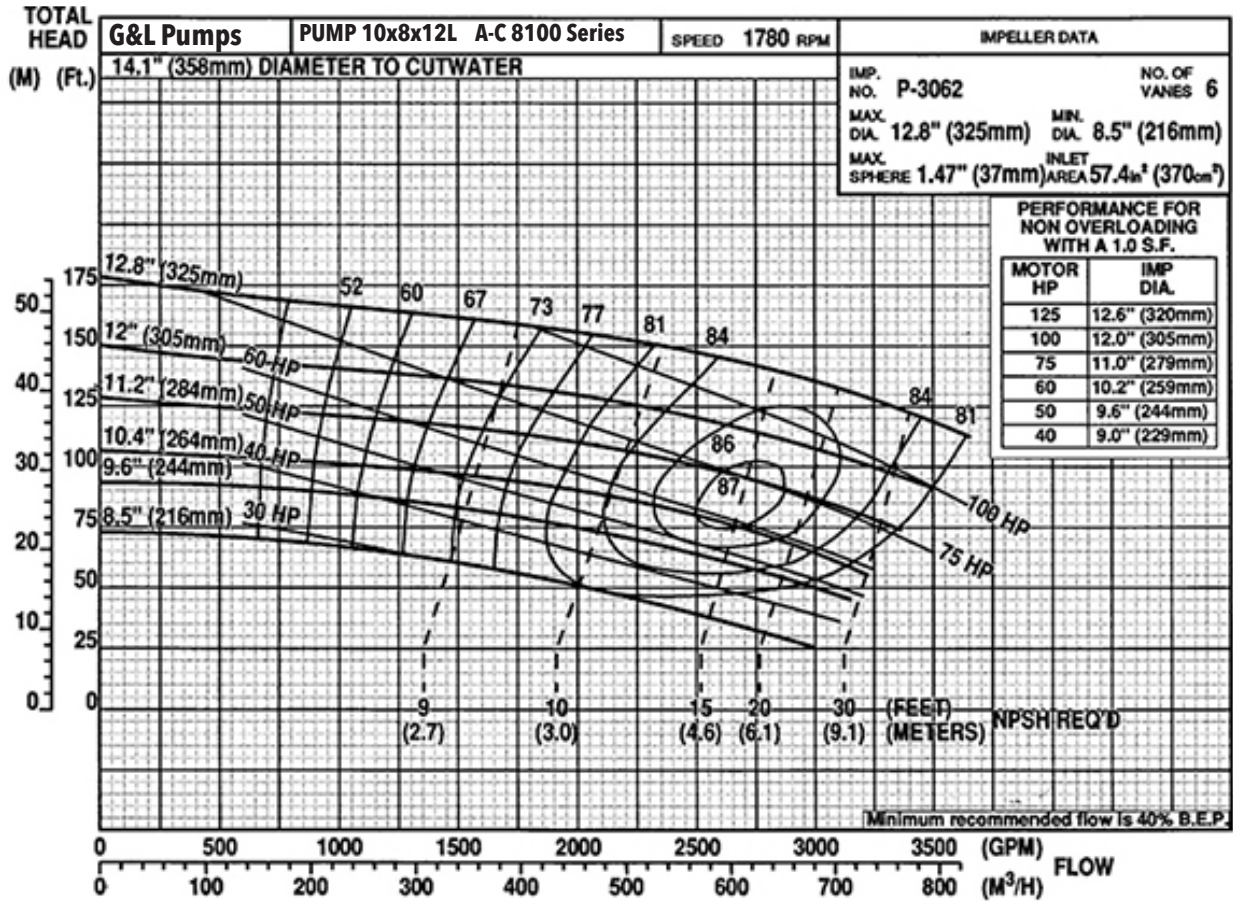

SERIES A-C 8100 - 60 Hz

1750 RPM PUMP CURVES

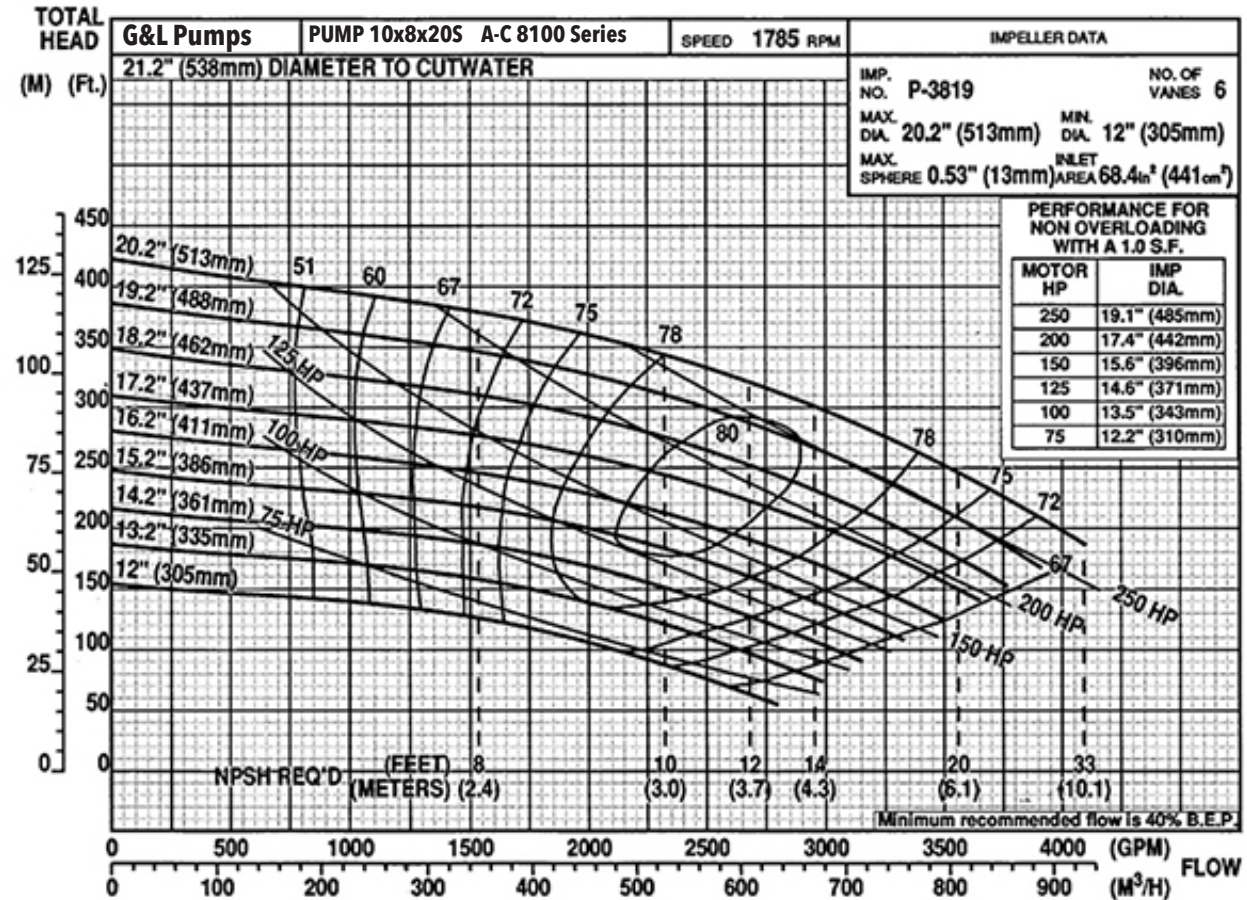
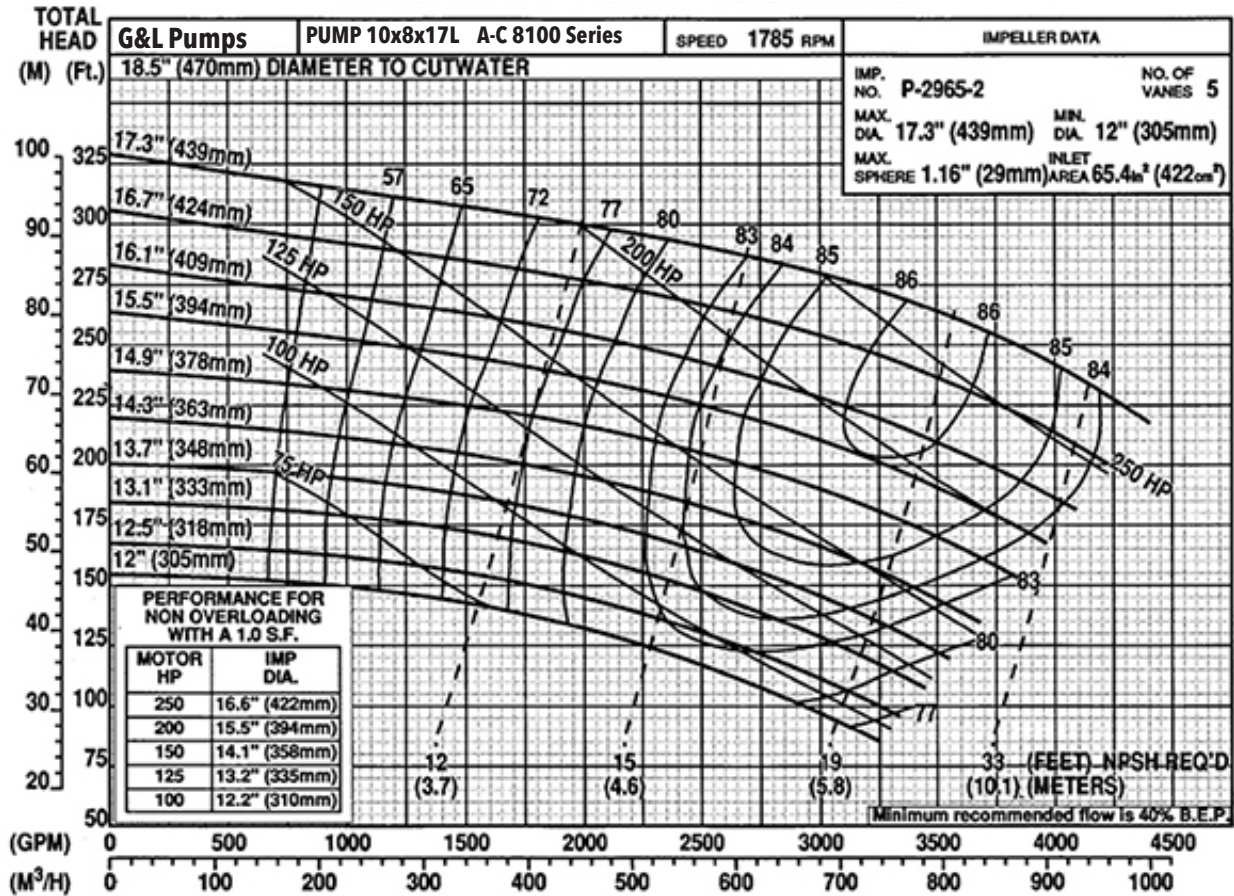

SERIES A-C 8100 - 60 Hz

1750 RPM PUMP CURVES

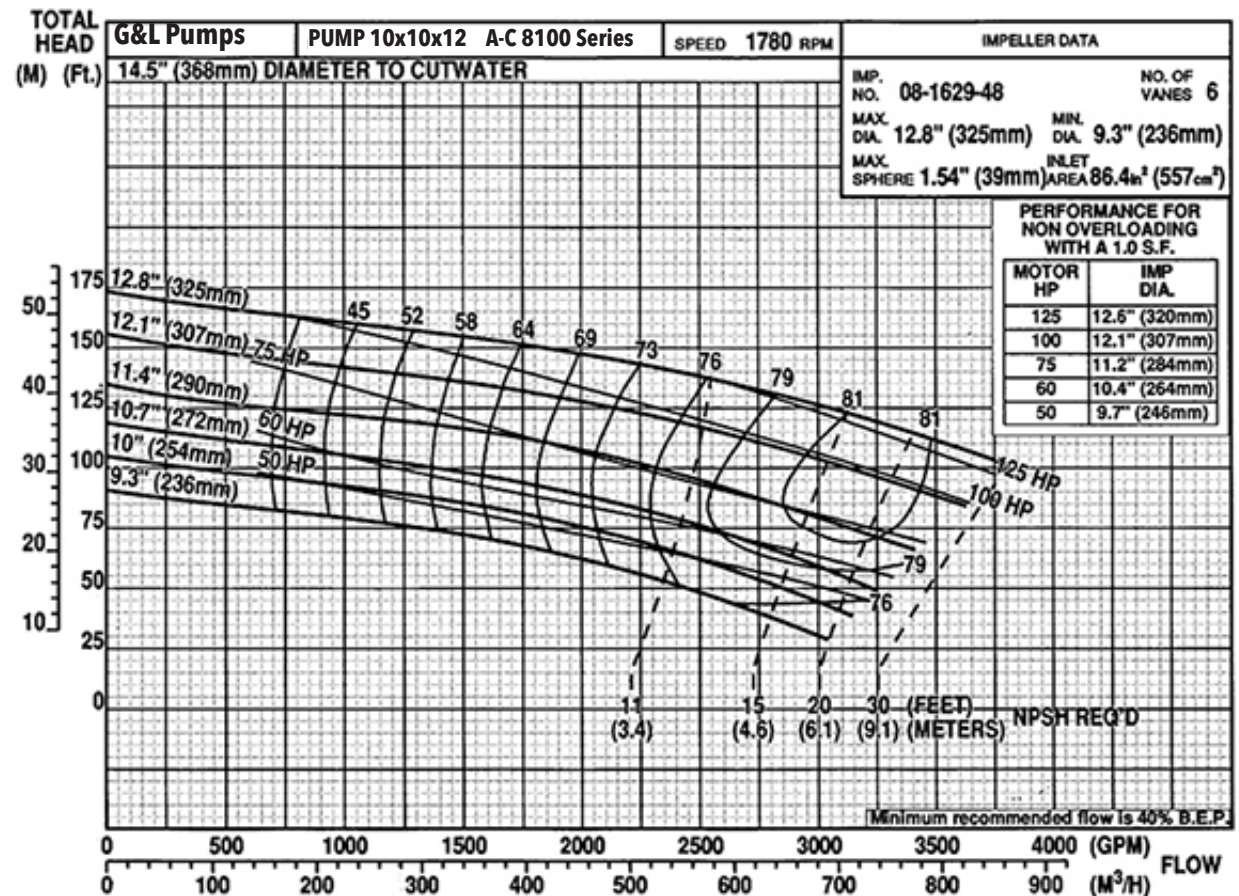
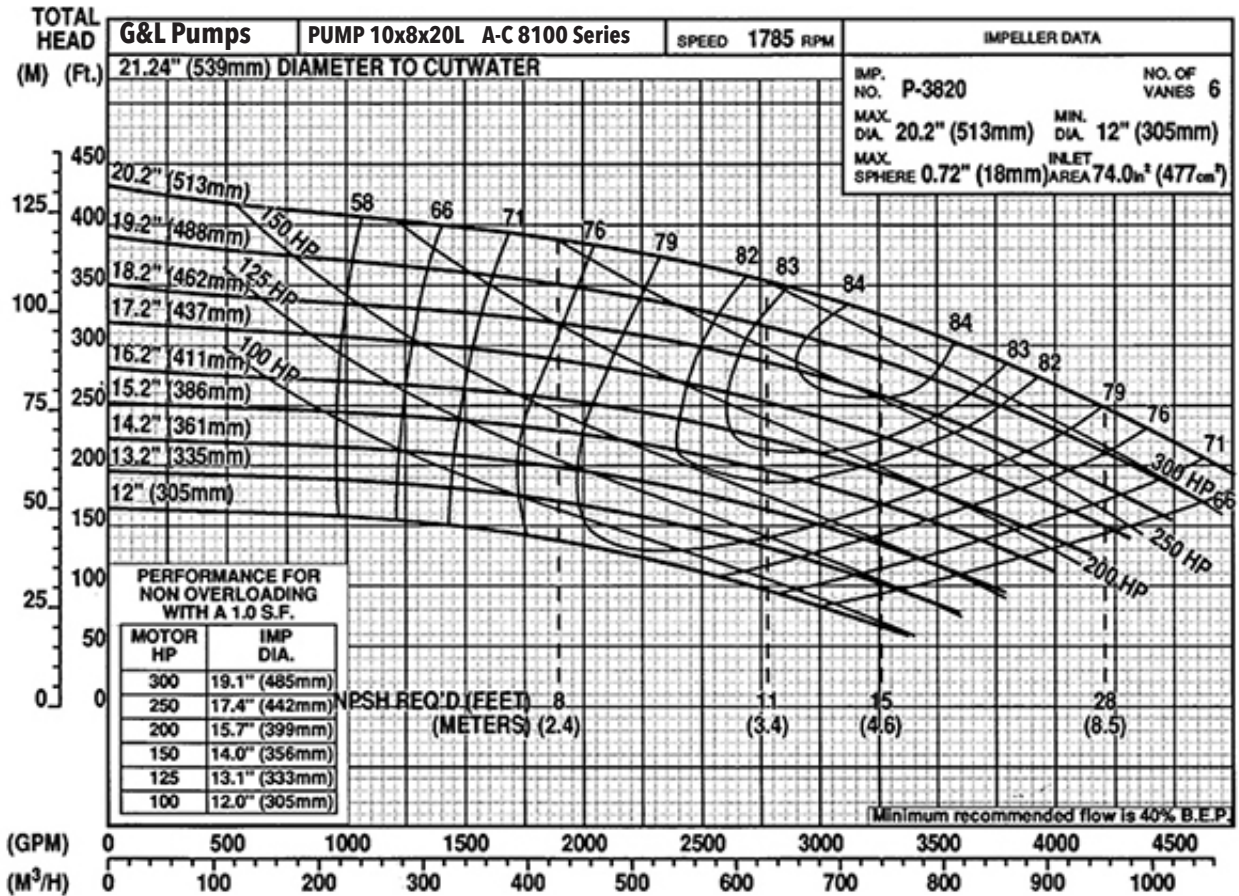

SERIES A-C 8100 - 60 Hz

1750 RPM PUMP CURVES

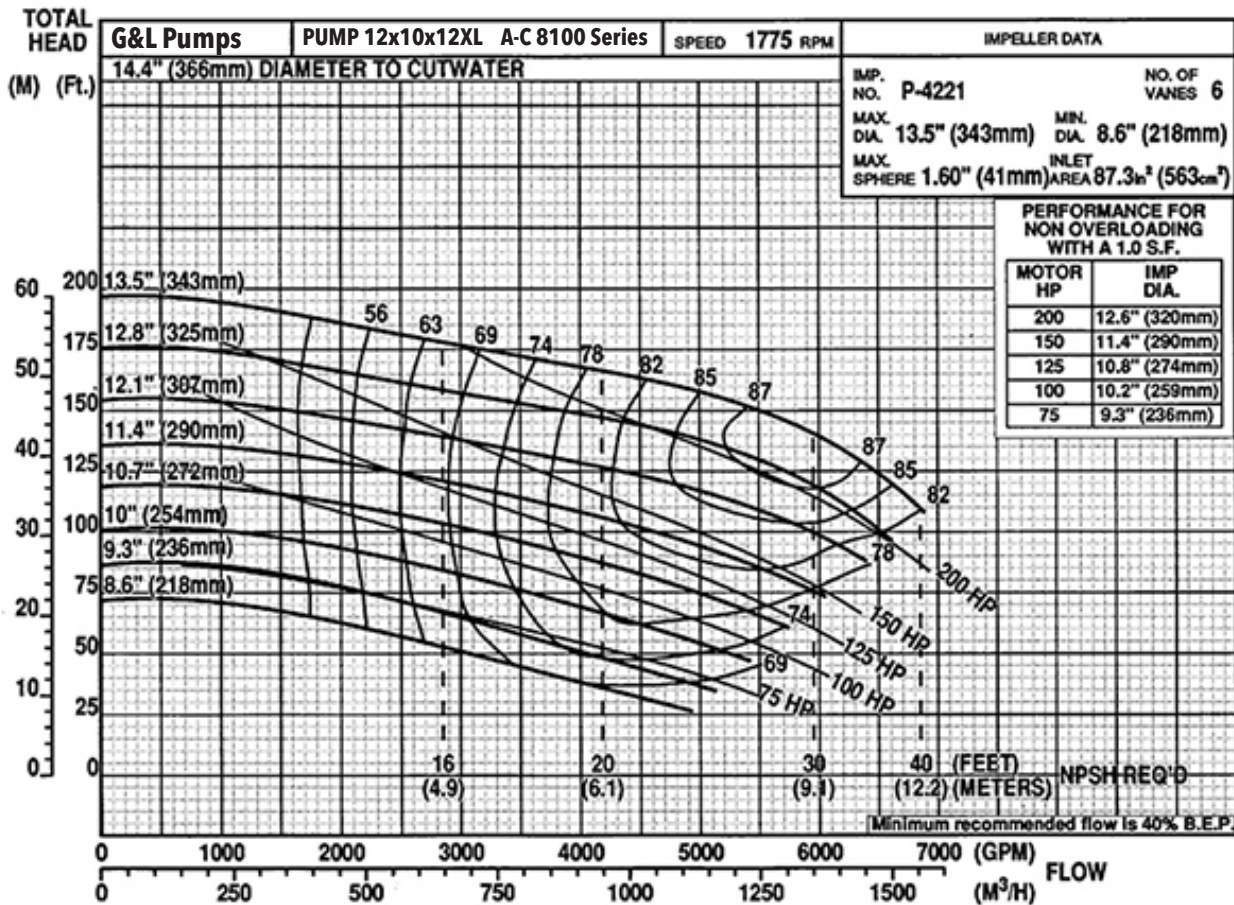
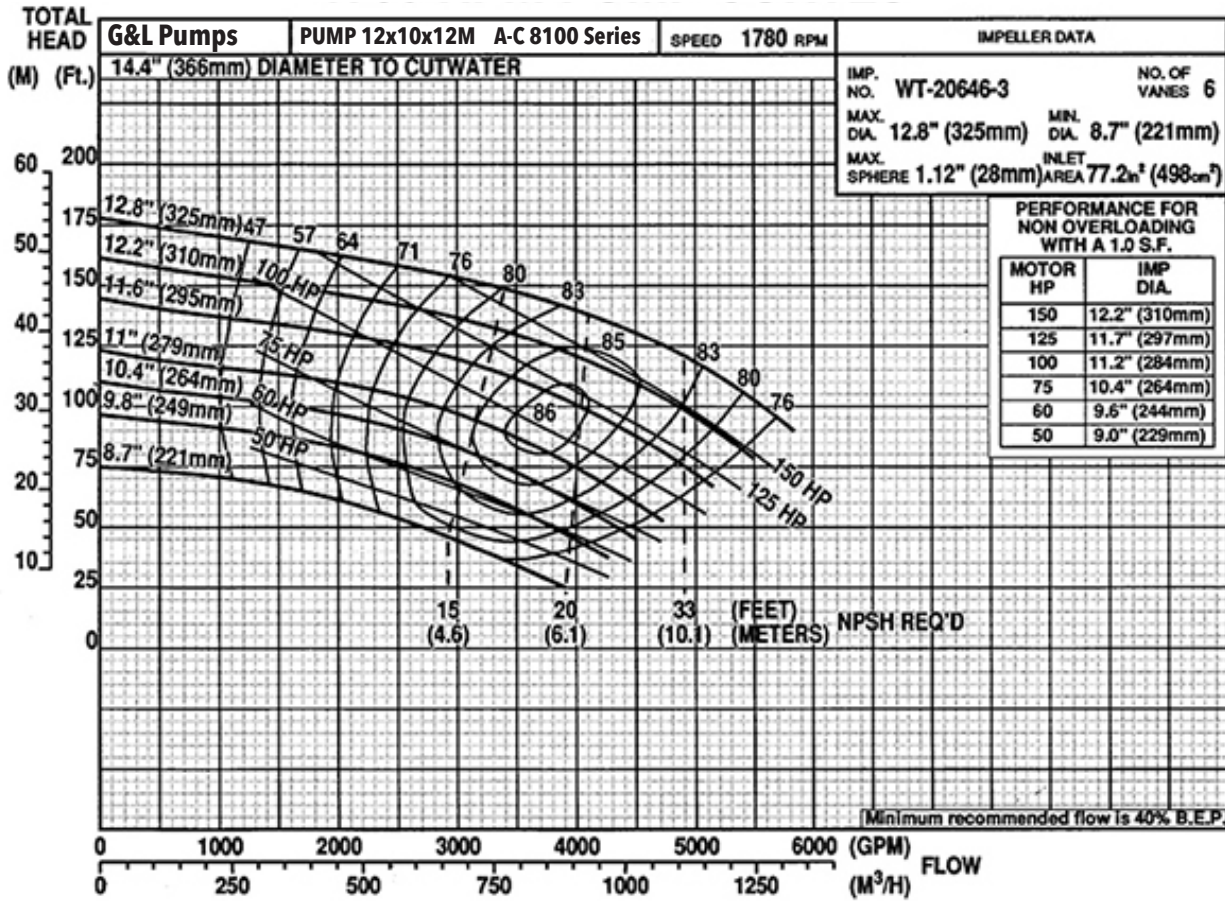

SERIES A-C 8100 - 60 Hz

1750 RPM PUMP CURVES

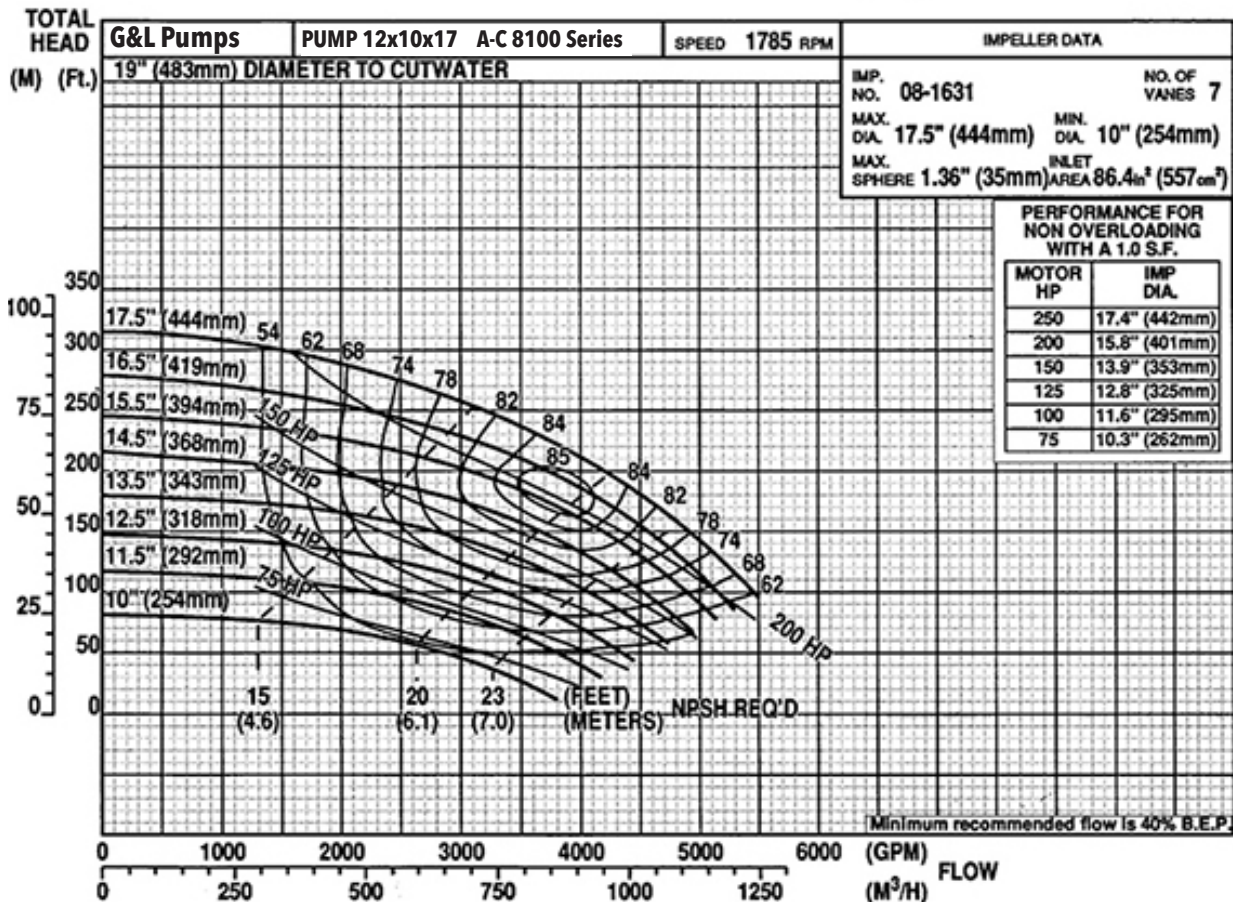
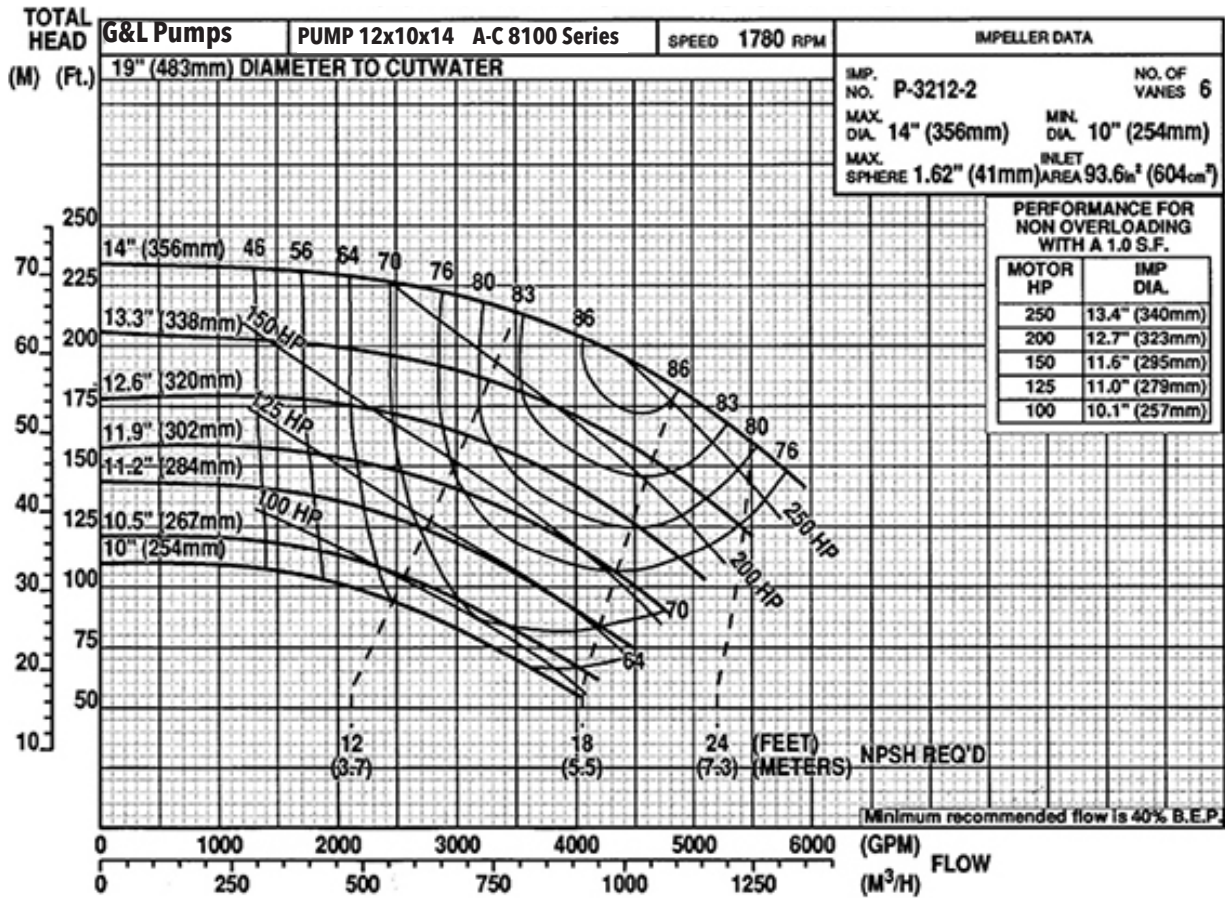

SERIES A-C 8100 - 60 Hz

1150 RPM PUMP CURVES

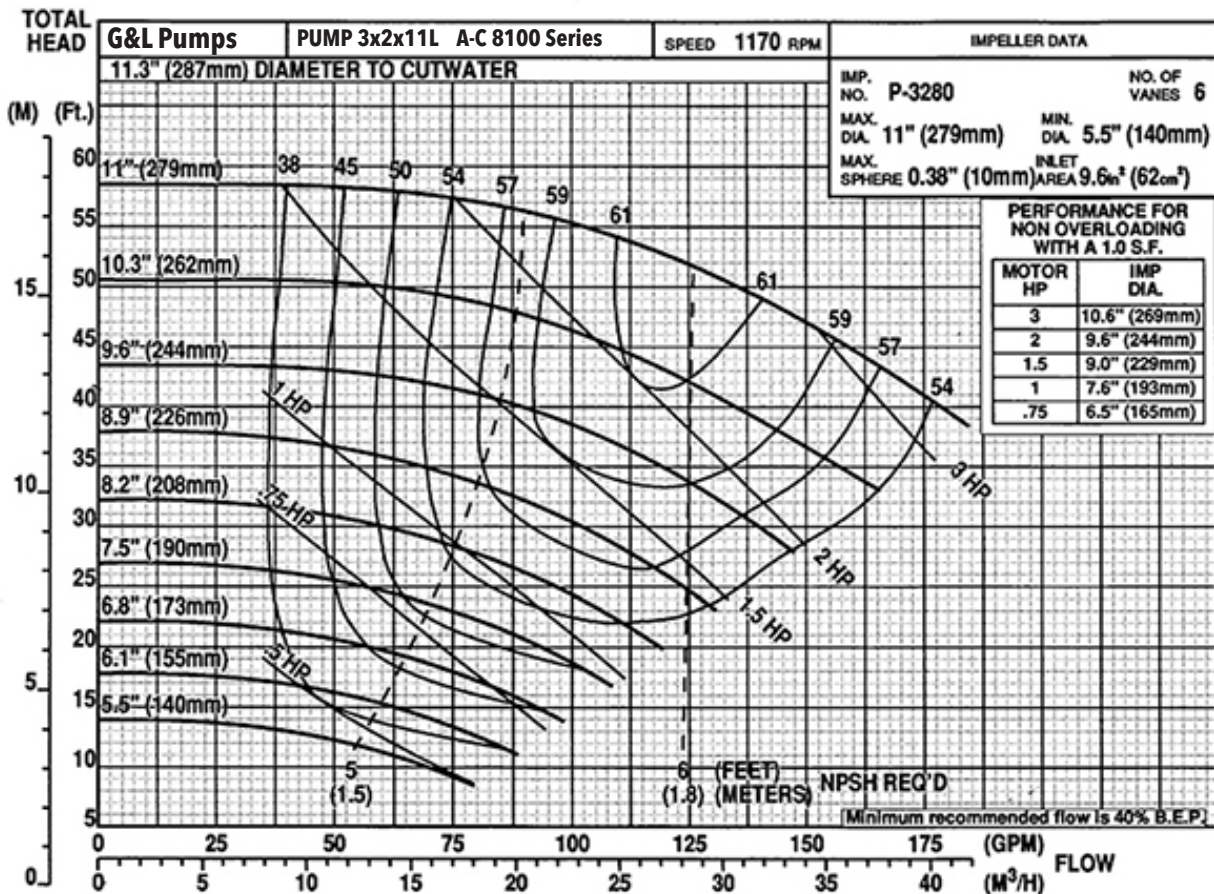
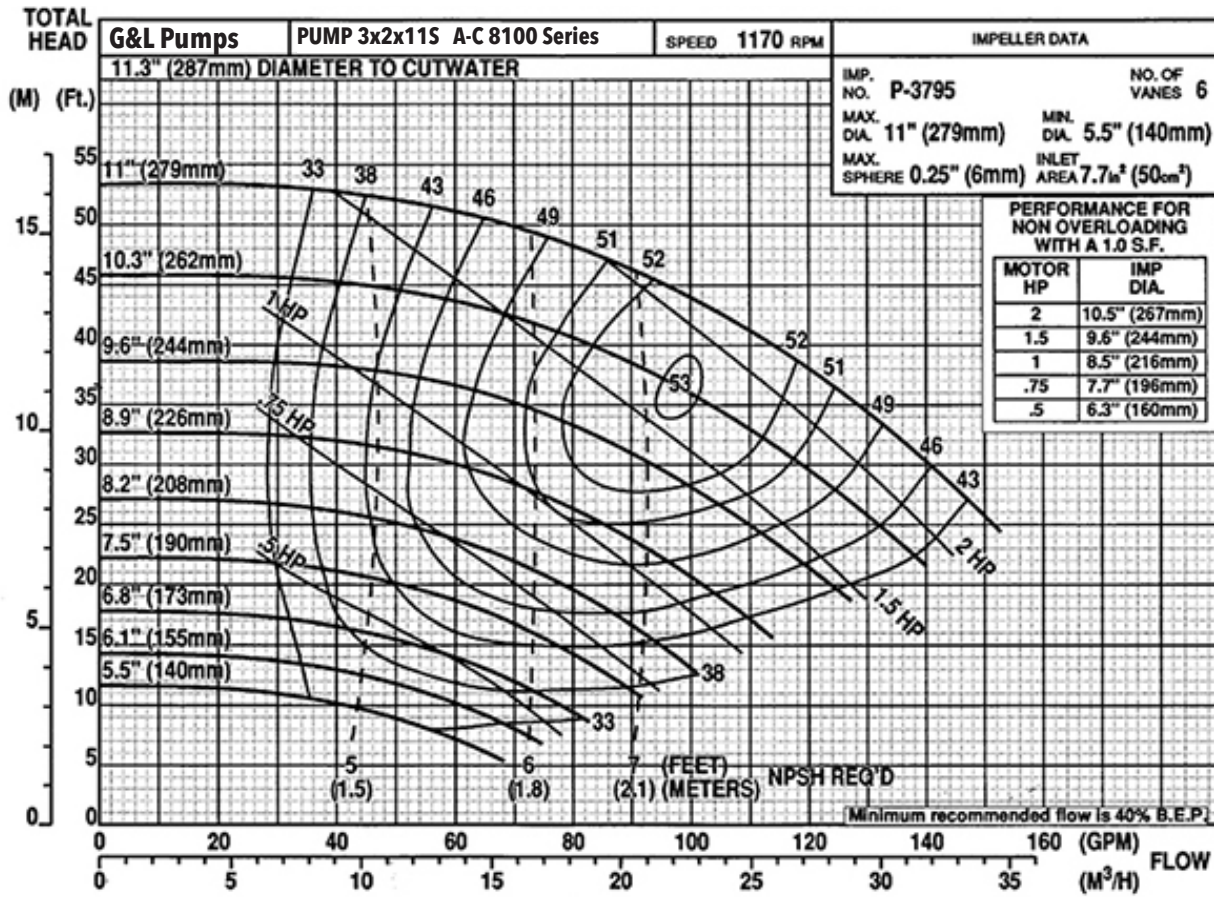

SERIES A-C 8100 - 60 Hz

1150 RPM PUMP CURVES

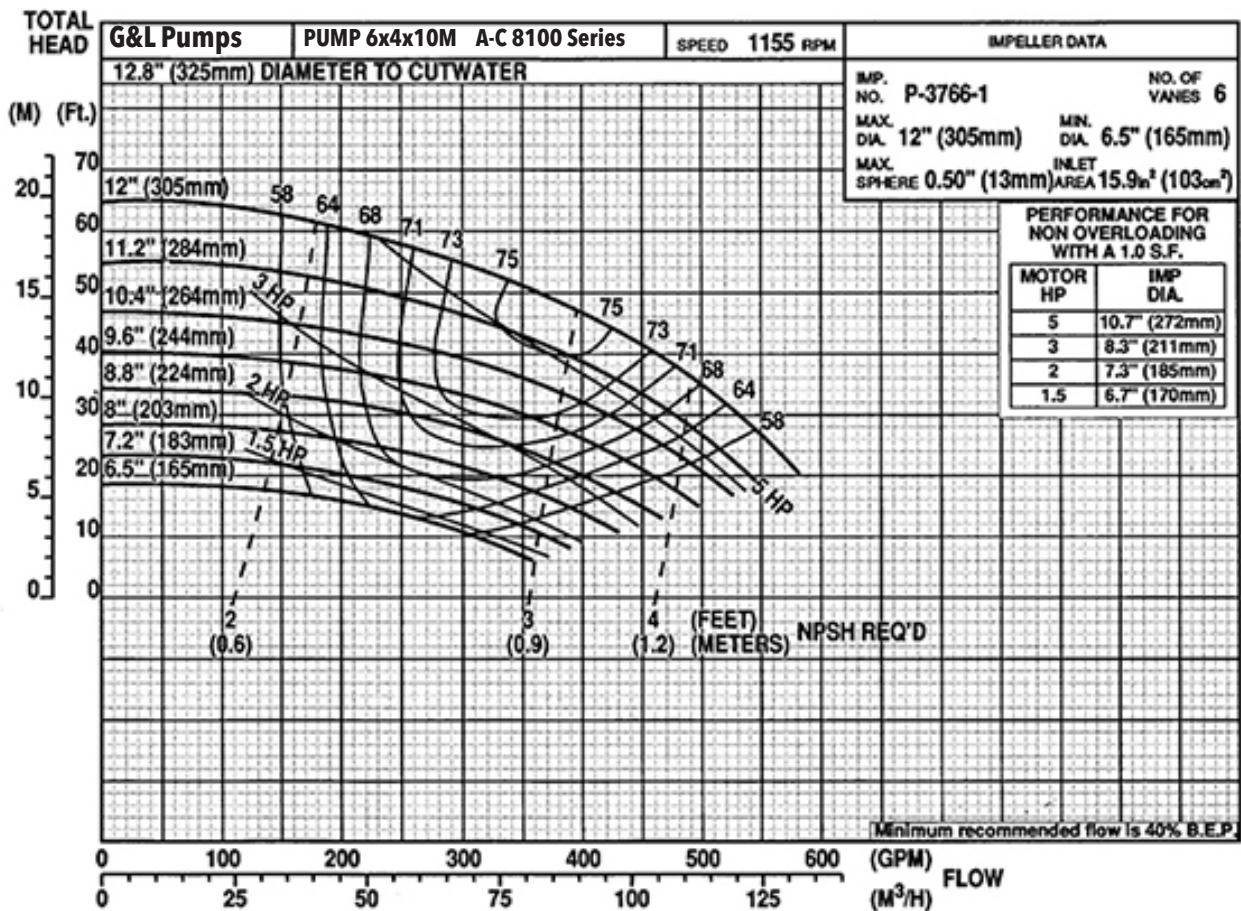
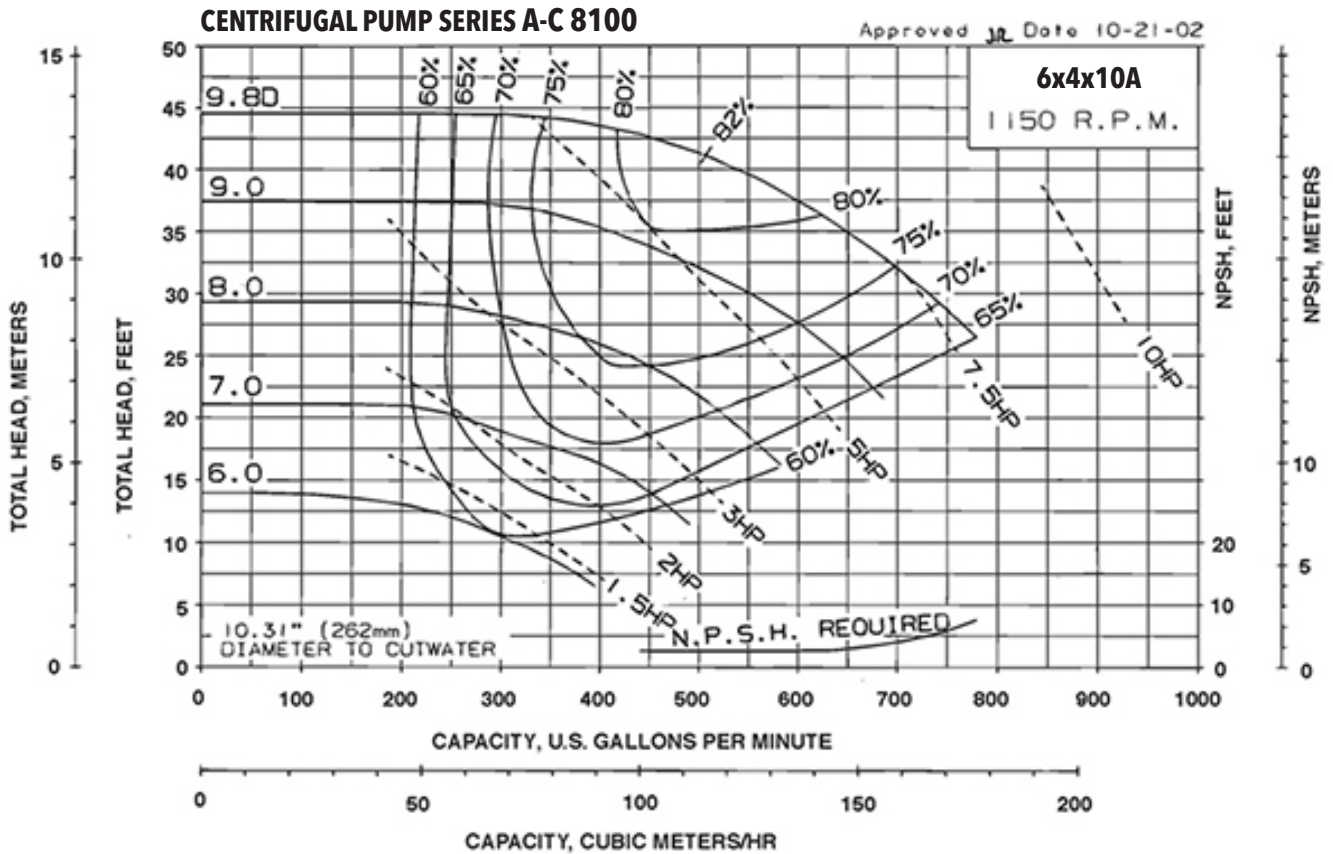

1150 RPM PUMP CURVES

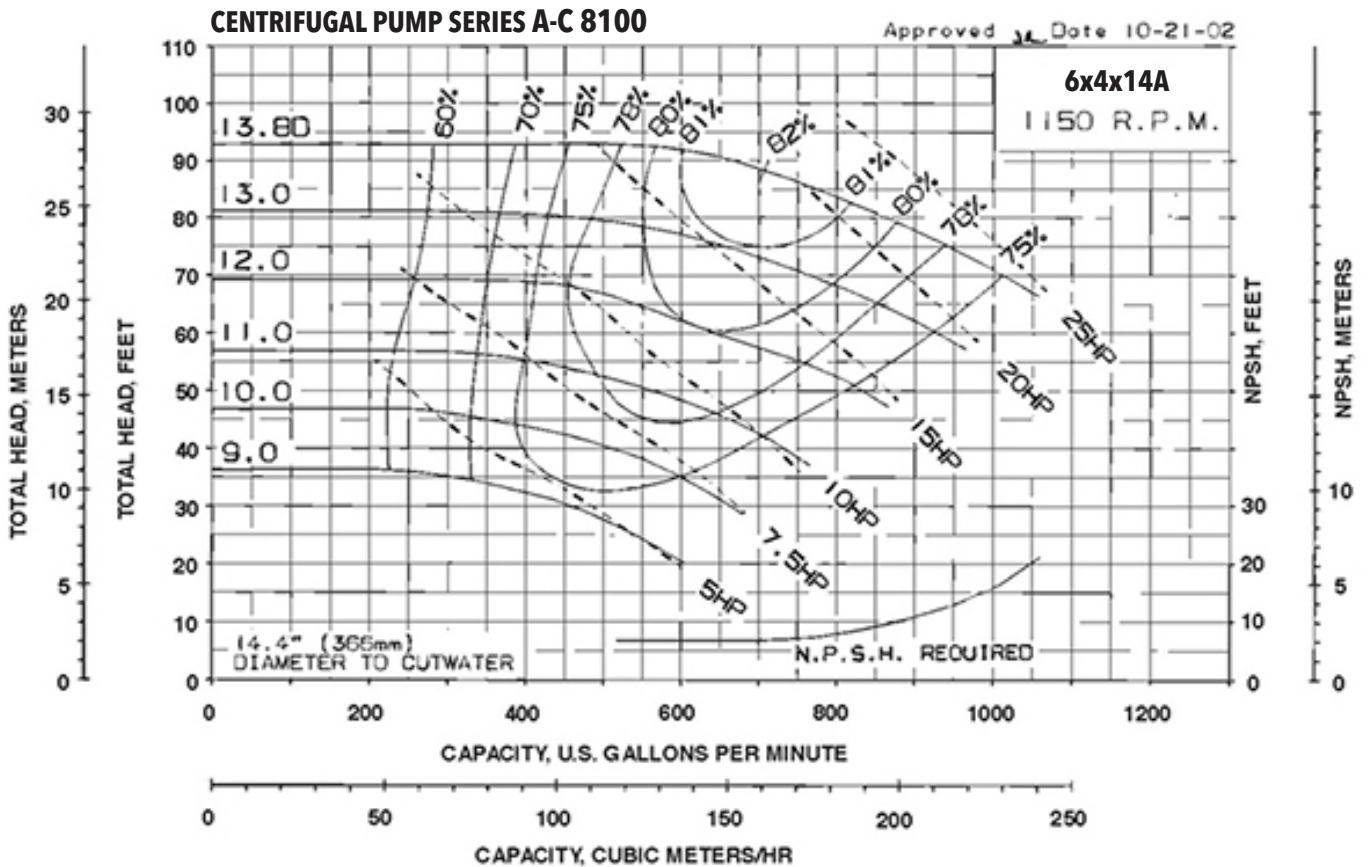
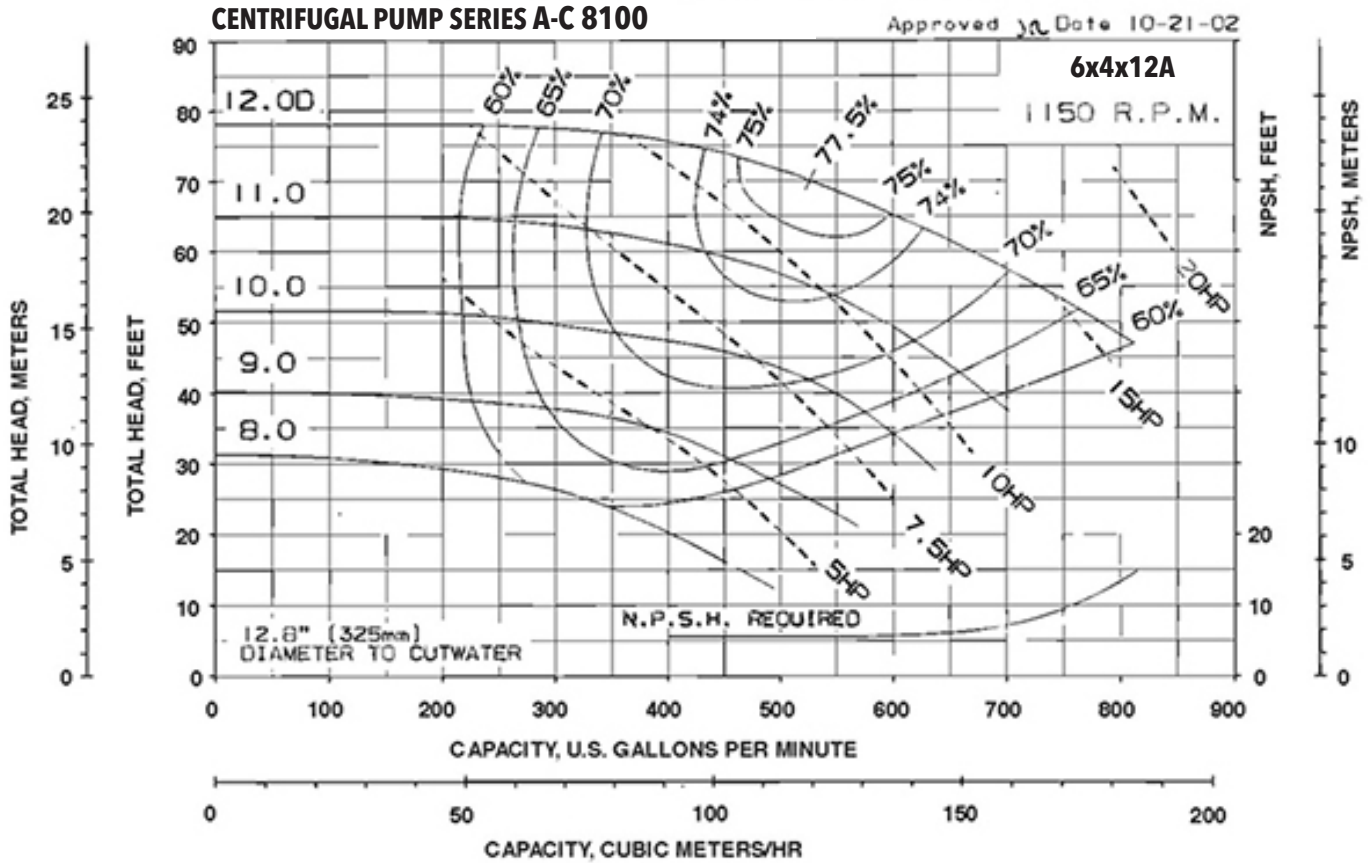

SERIES A-C 8100 - 60 Hz

1150 RPM PUMP CURVES

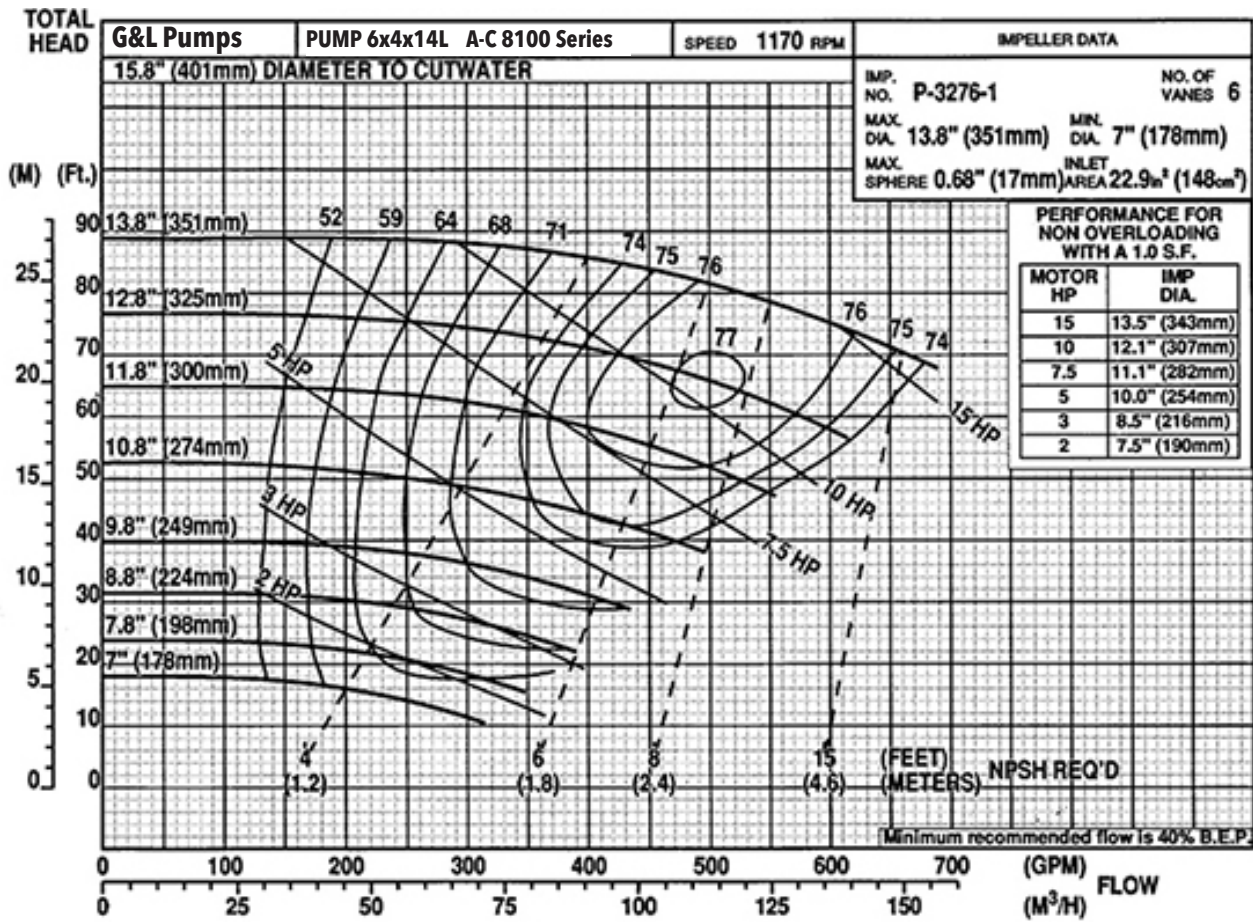

CENTRIFUGAL PUMP SERIES A-C 8100

Approved *ja* Date 10-21-02

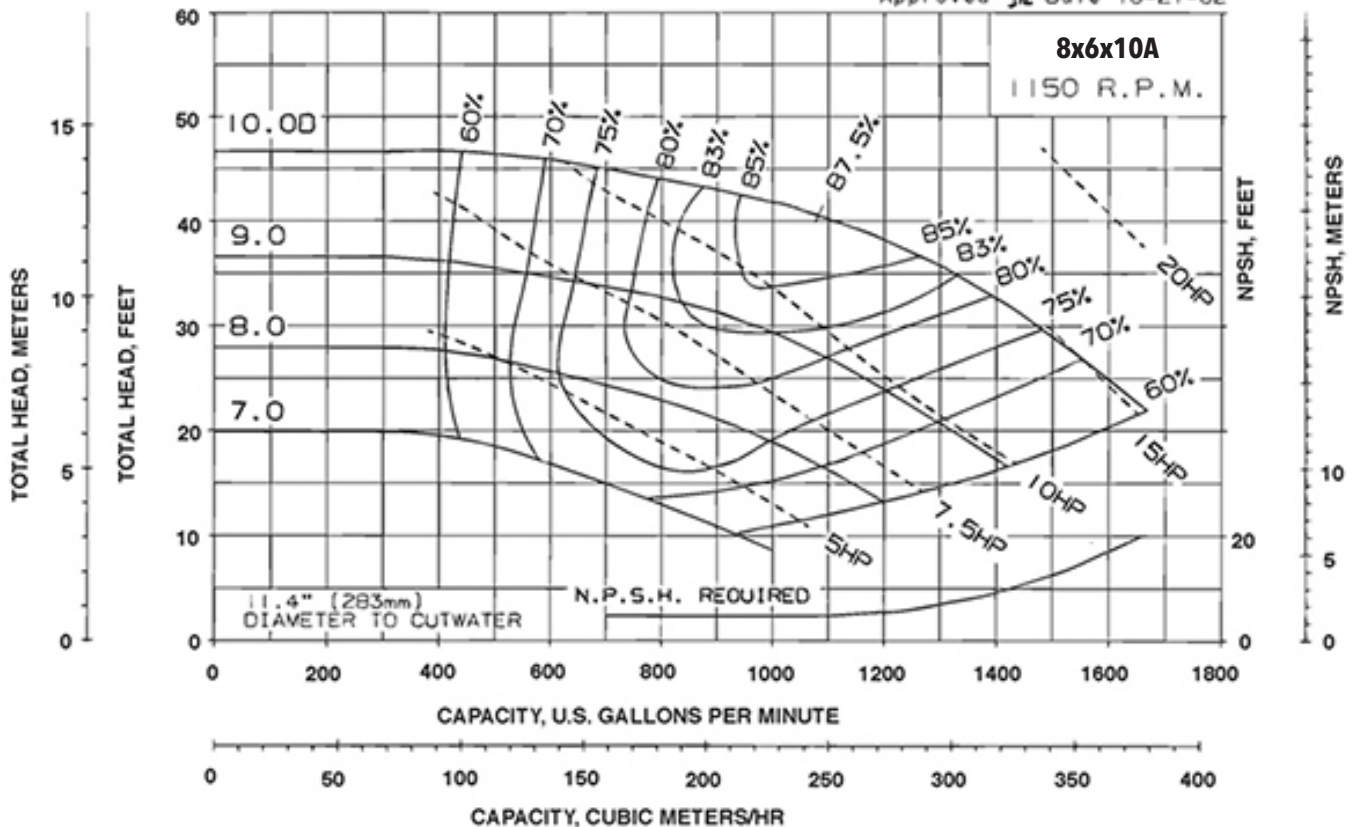

SERIES A-C 8100 - 60 Hz

1150 RPM PUMP CURVES

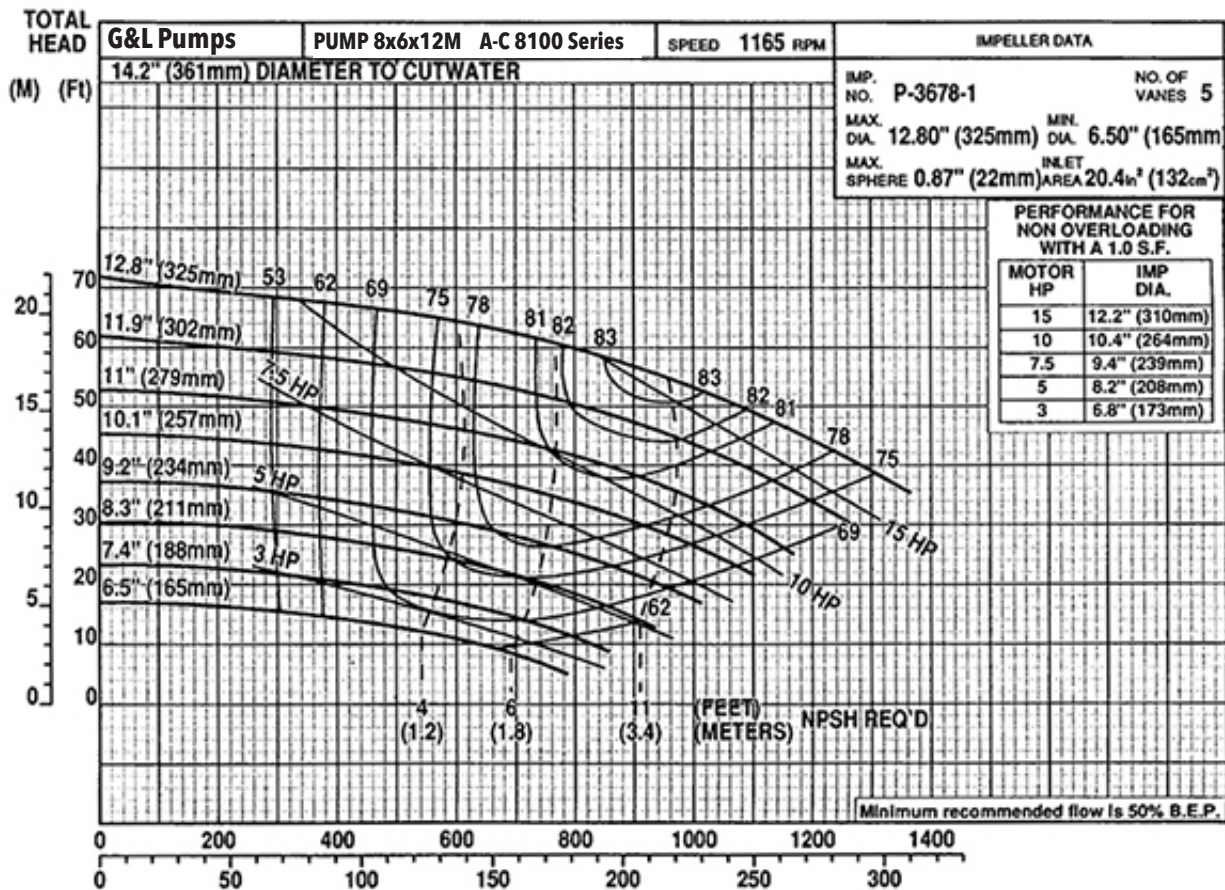
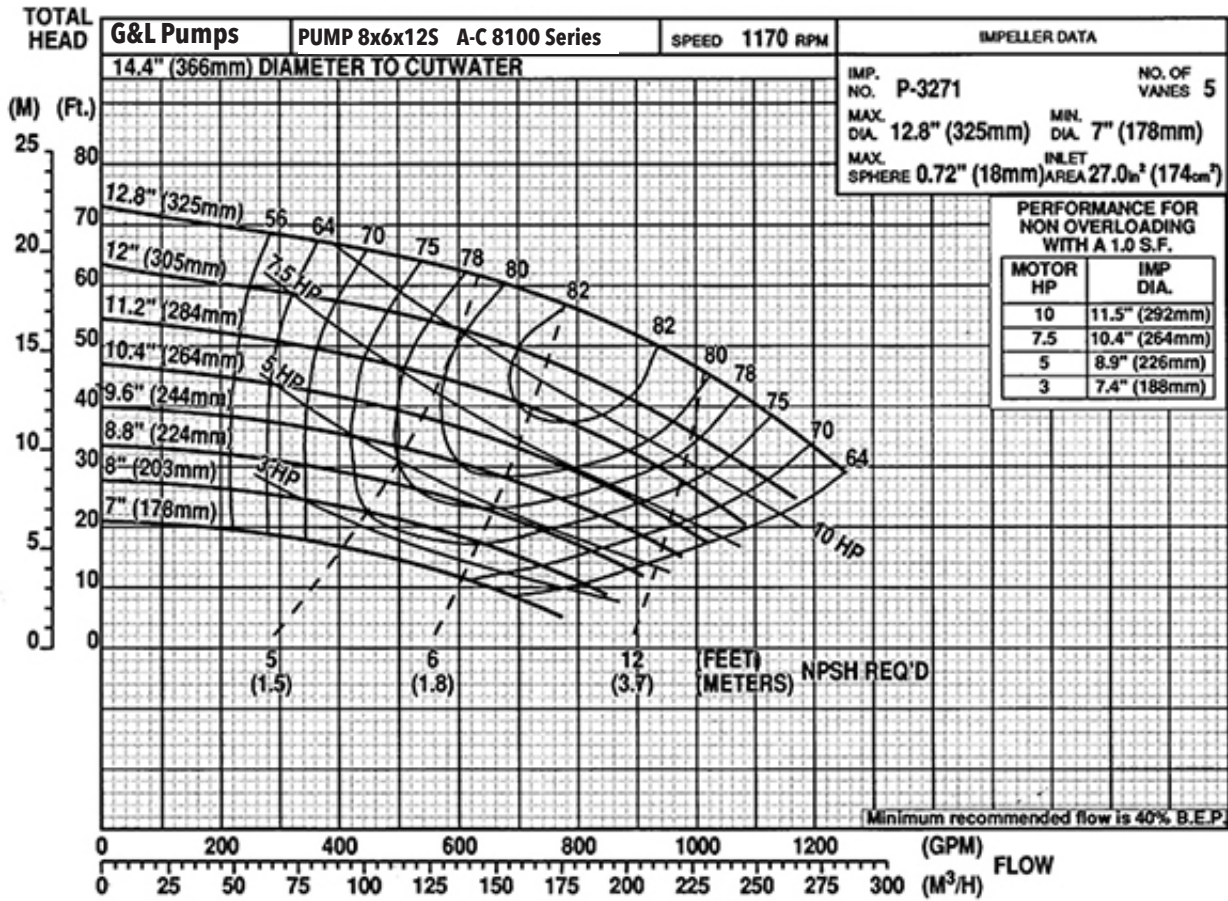

SERIES A-C 8100 - 60 Hz

1150 RPM PUMP CURVES

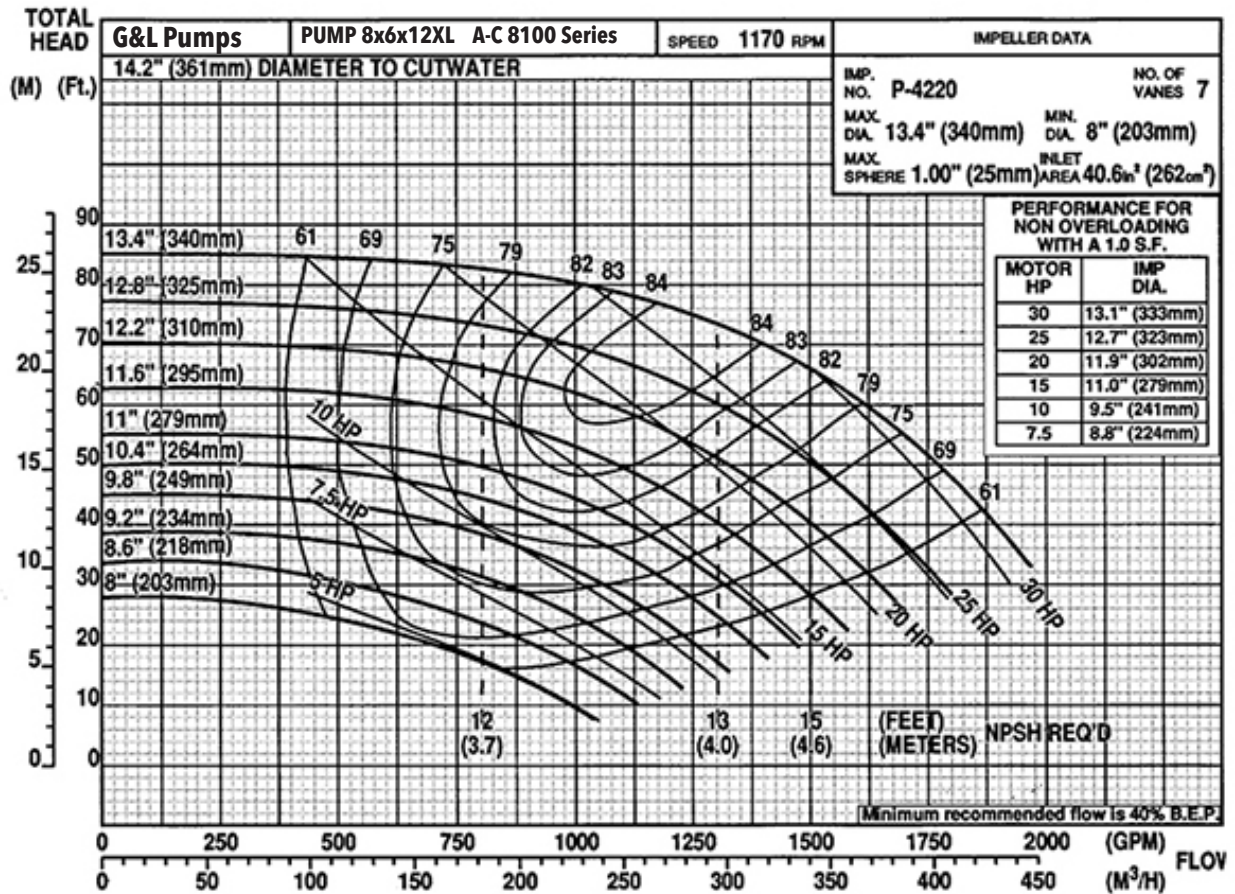
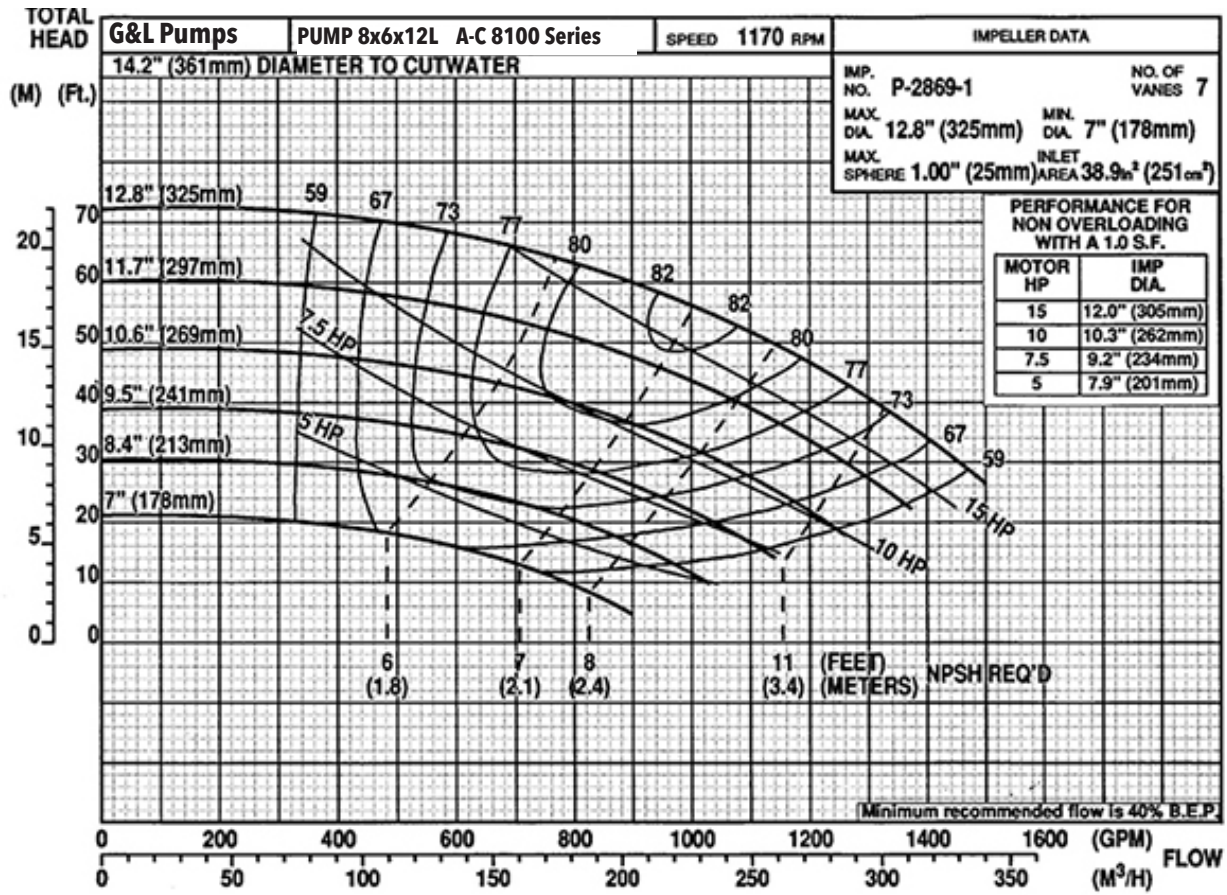

SERIES A-C 8100 - 60 Hz

1150 RPM PUMP CURVES

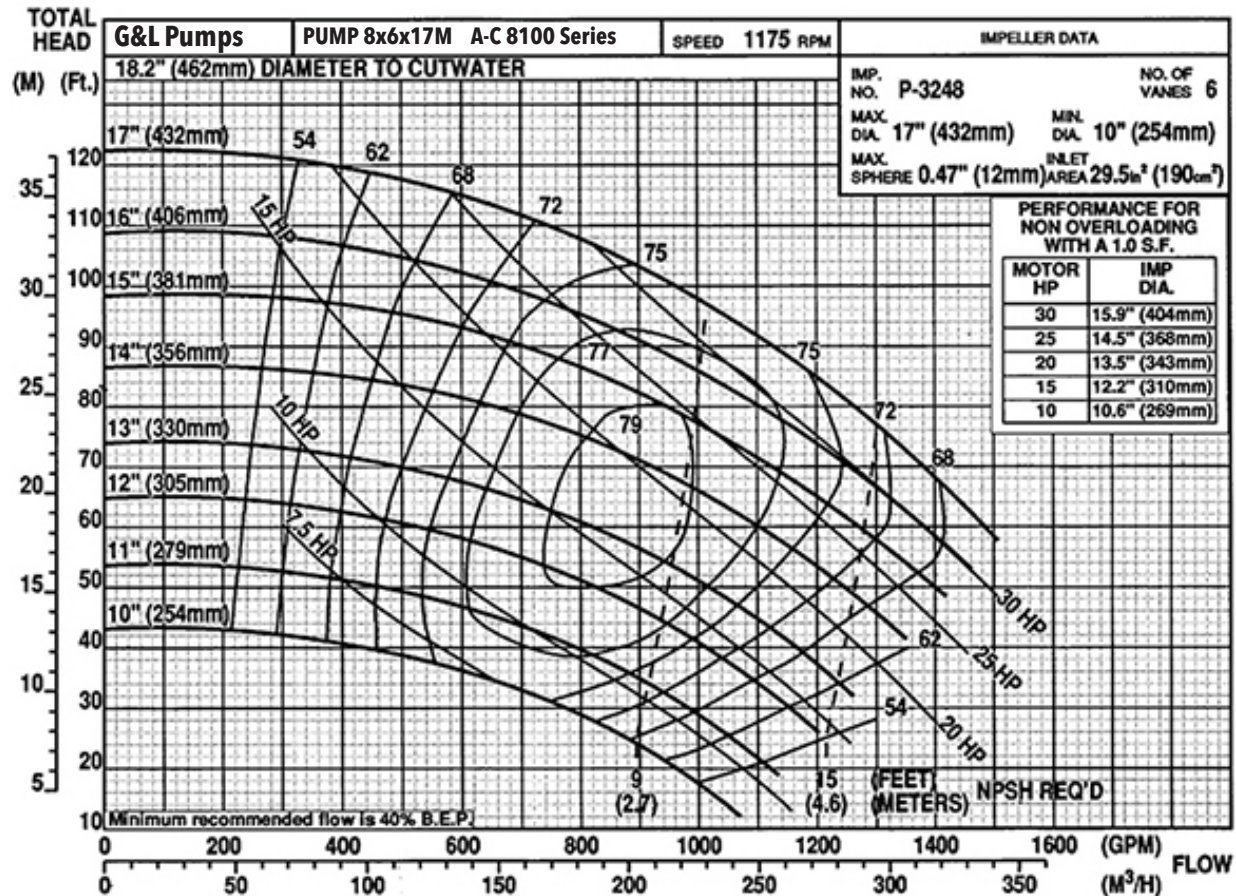
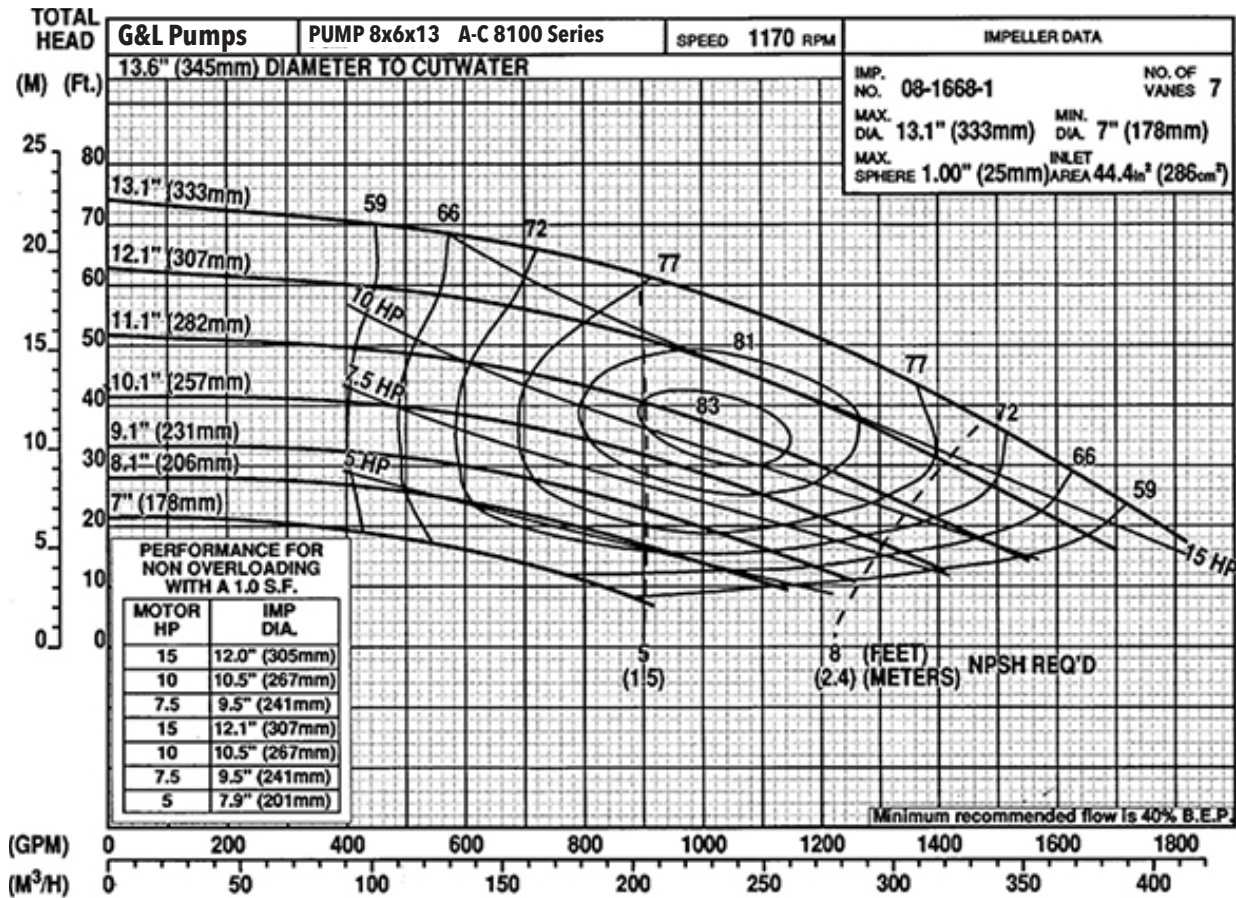

SERIES A-C 8100 - 60 Hz

1150 RPM PUMP CURVES

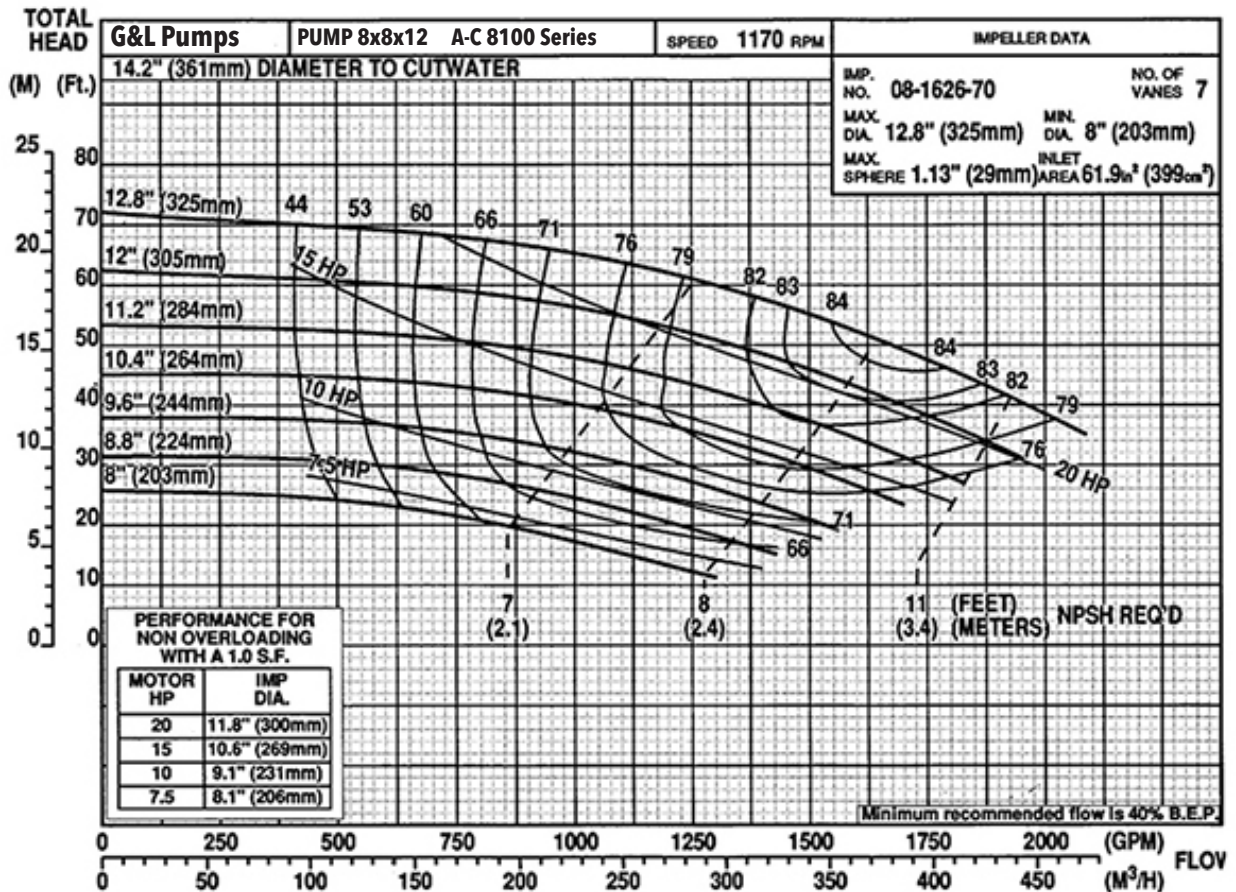
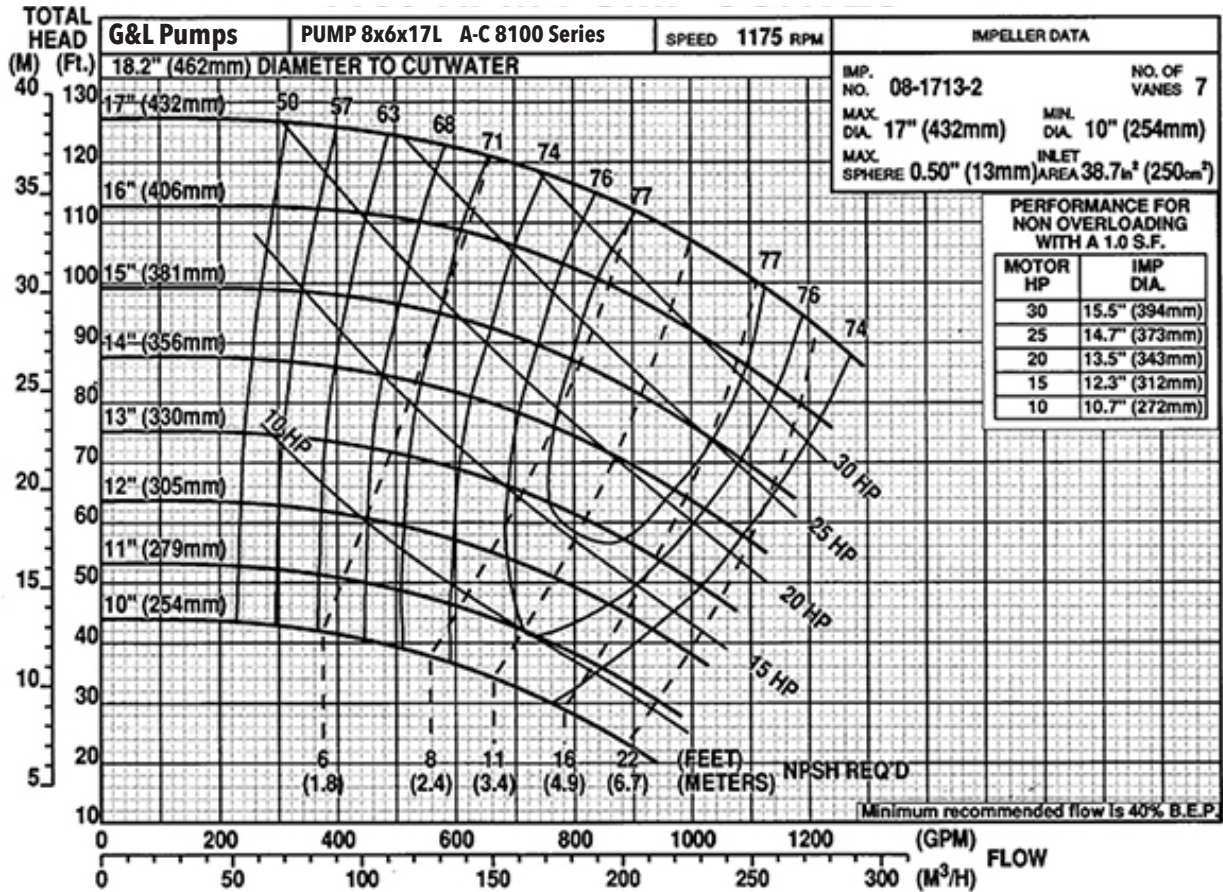

SERIES A-C 8100 - 60 Hz

1150 RPM PUMP CURVES

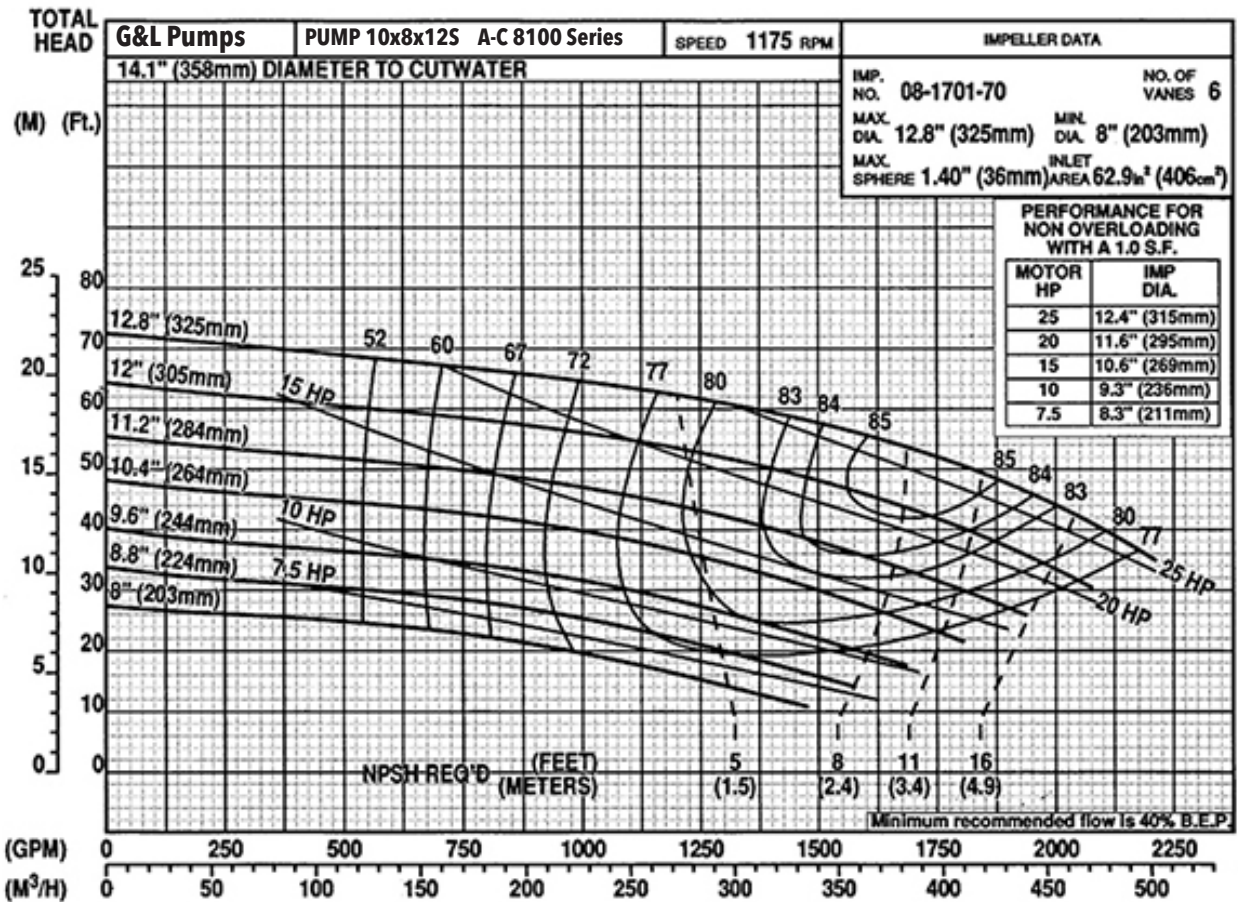
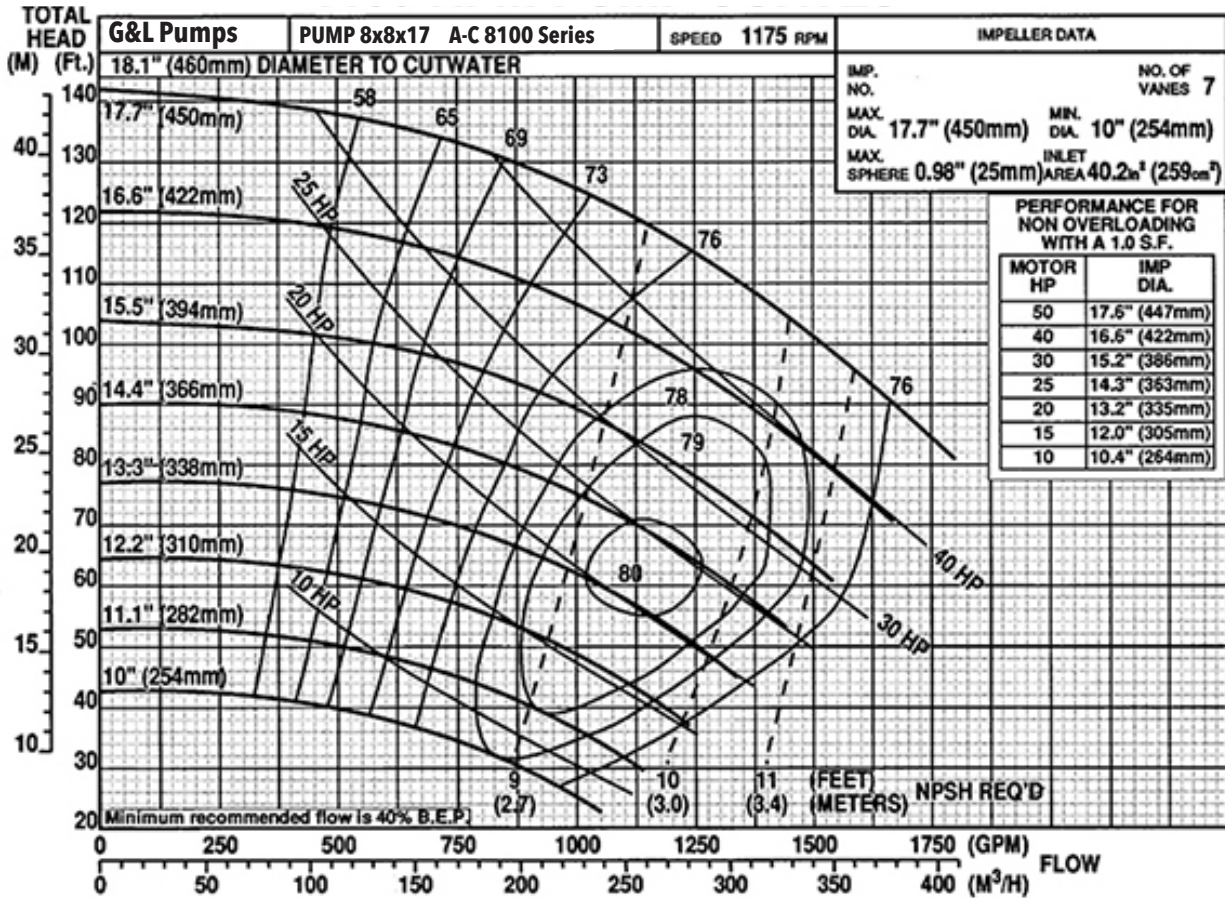

SERIES A-C 8100 - 60 Hz

1150 RPM PUMP CURVES

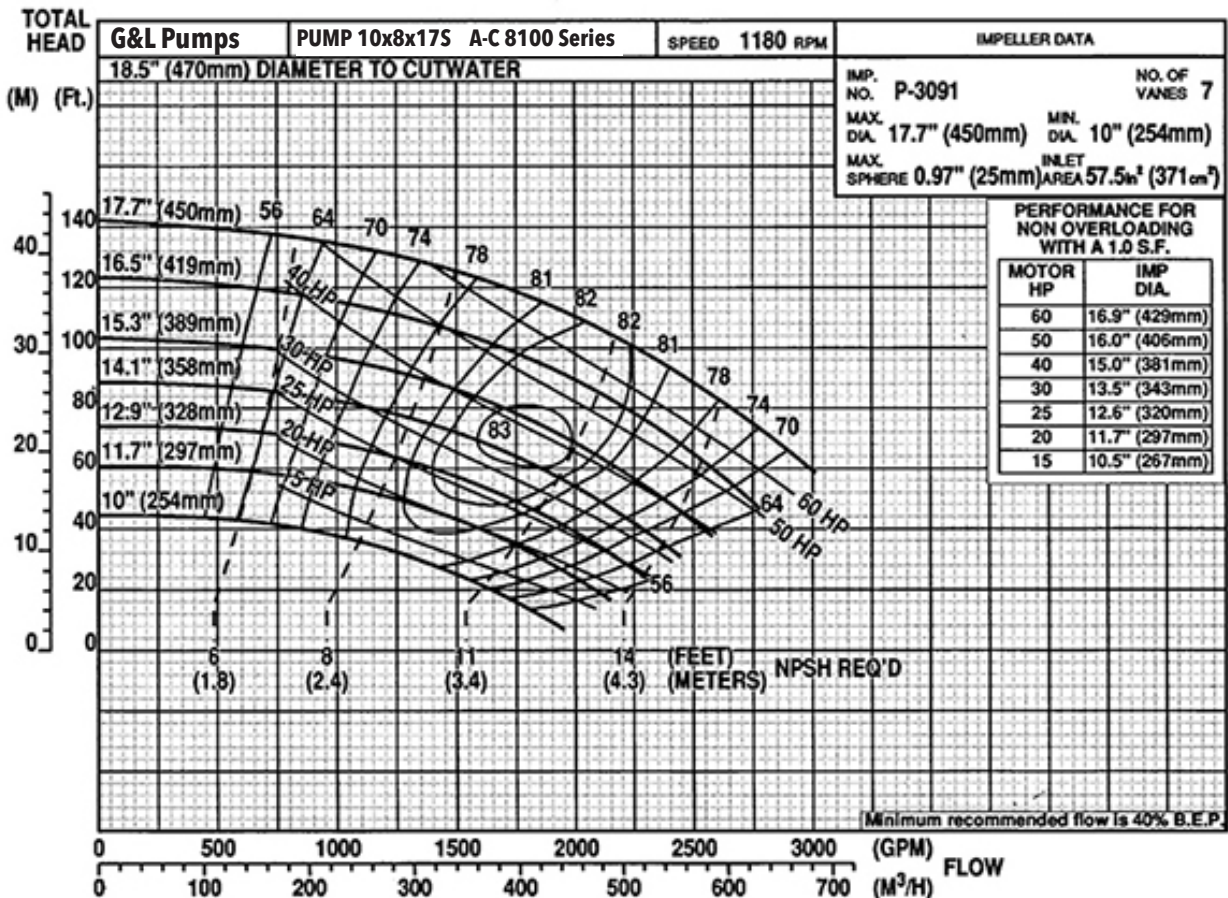
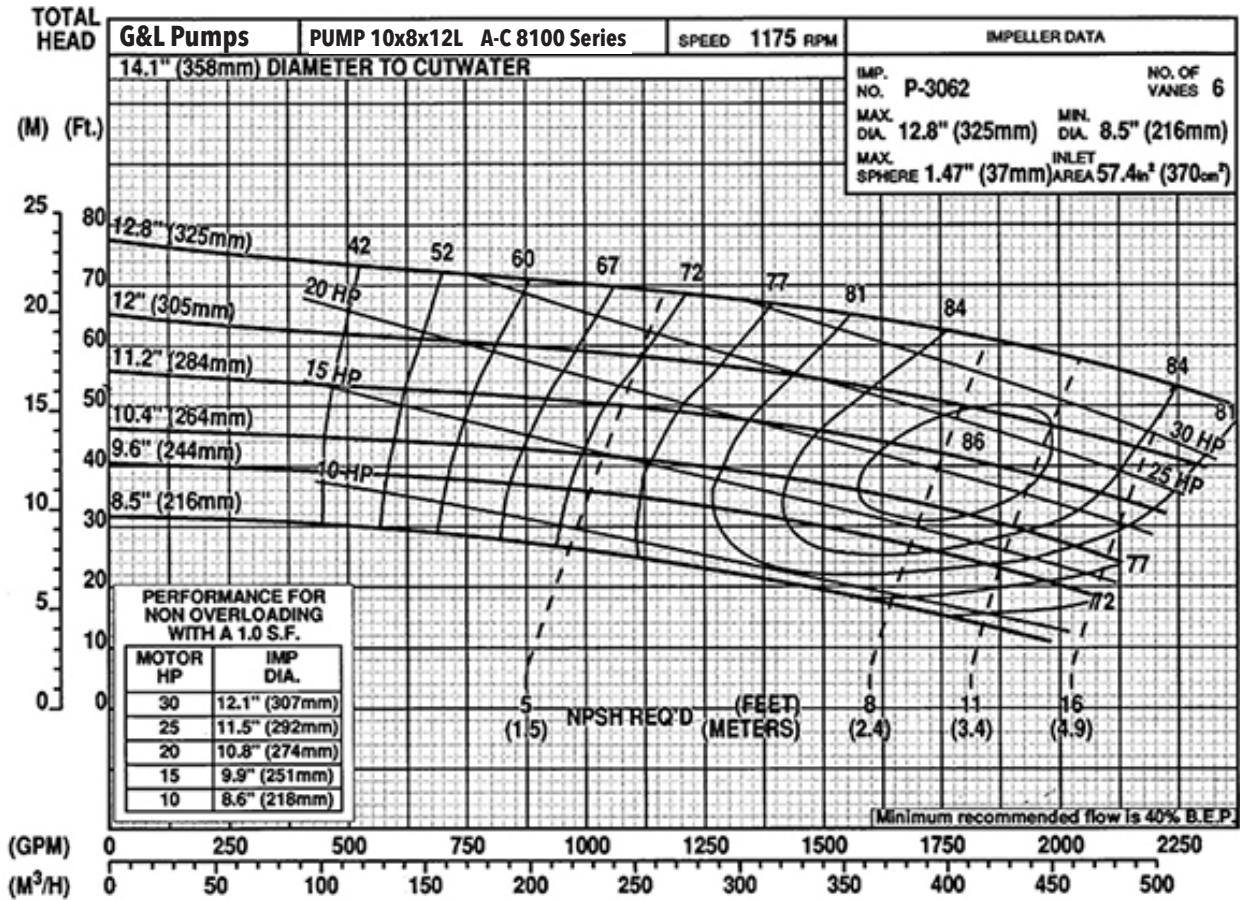

SERIES A-C 8100 - 60 Hz

1150 RPM PUMP CURVES

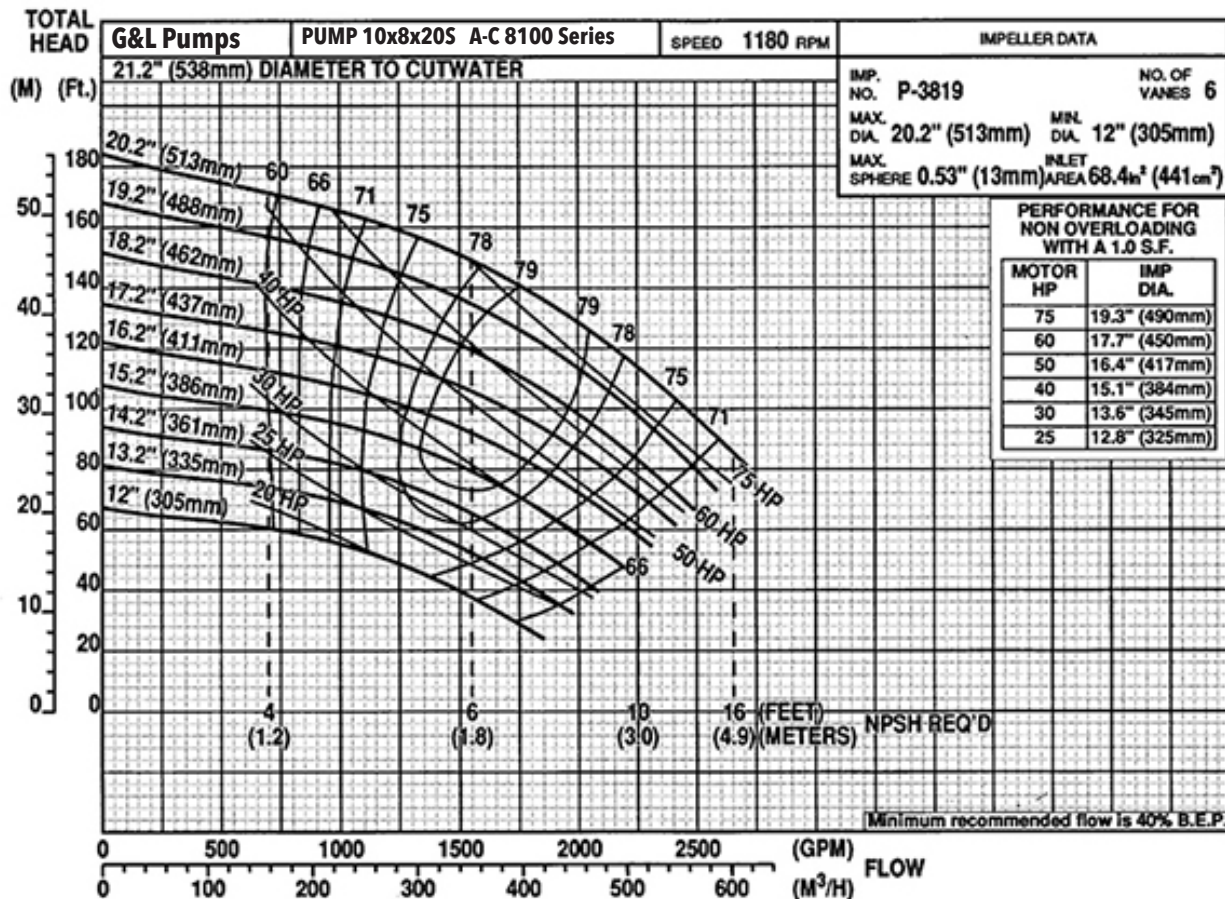
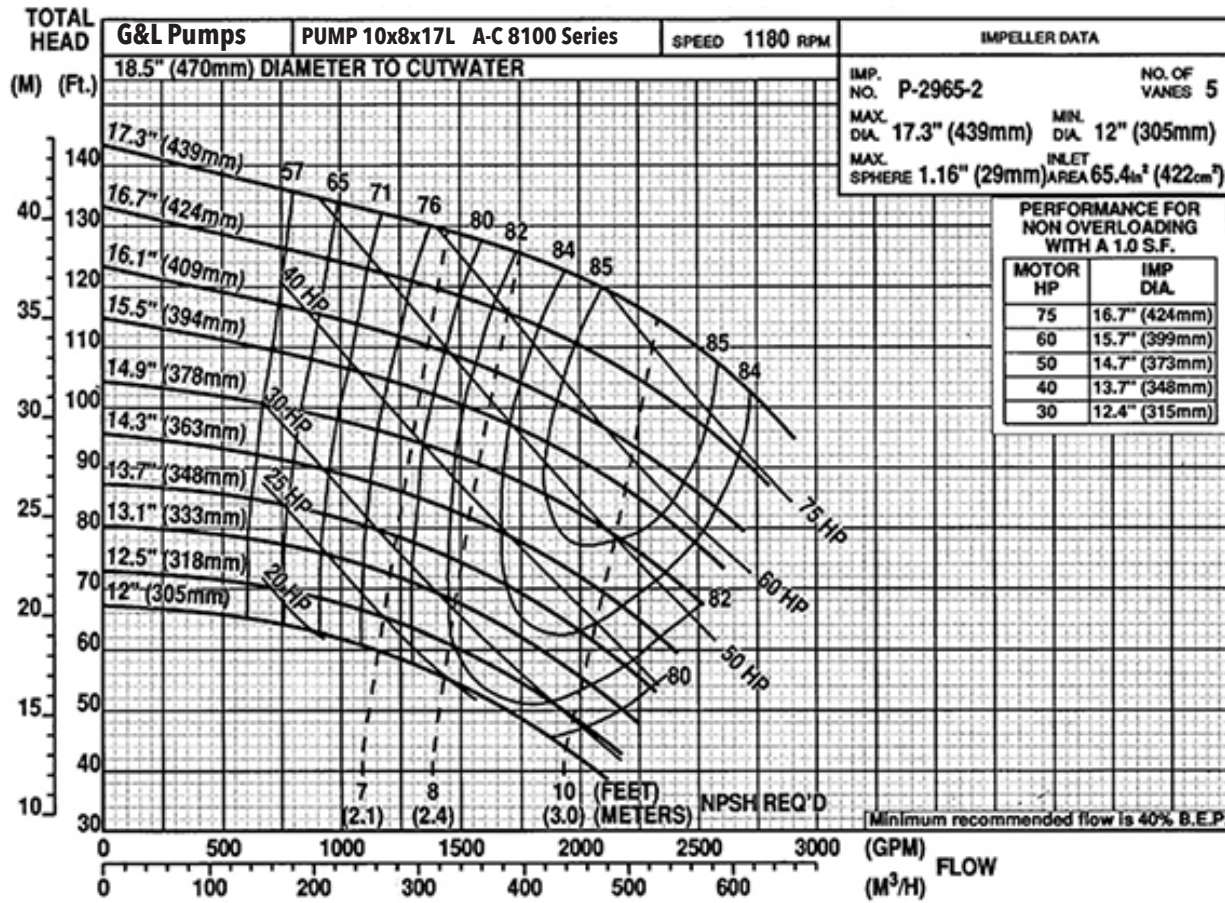

SERIES A-C 8100 - 60 Hz

1150 RPM PUMP CURVES

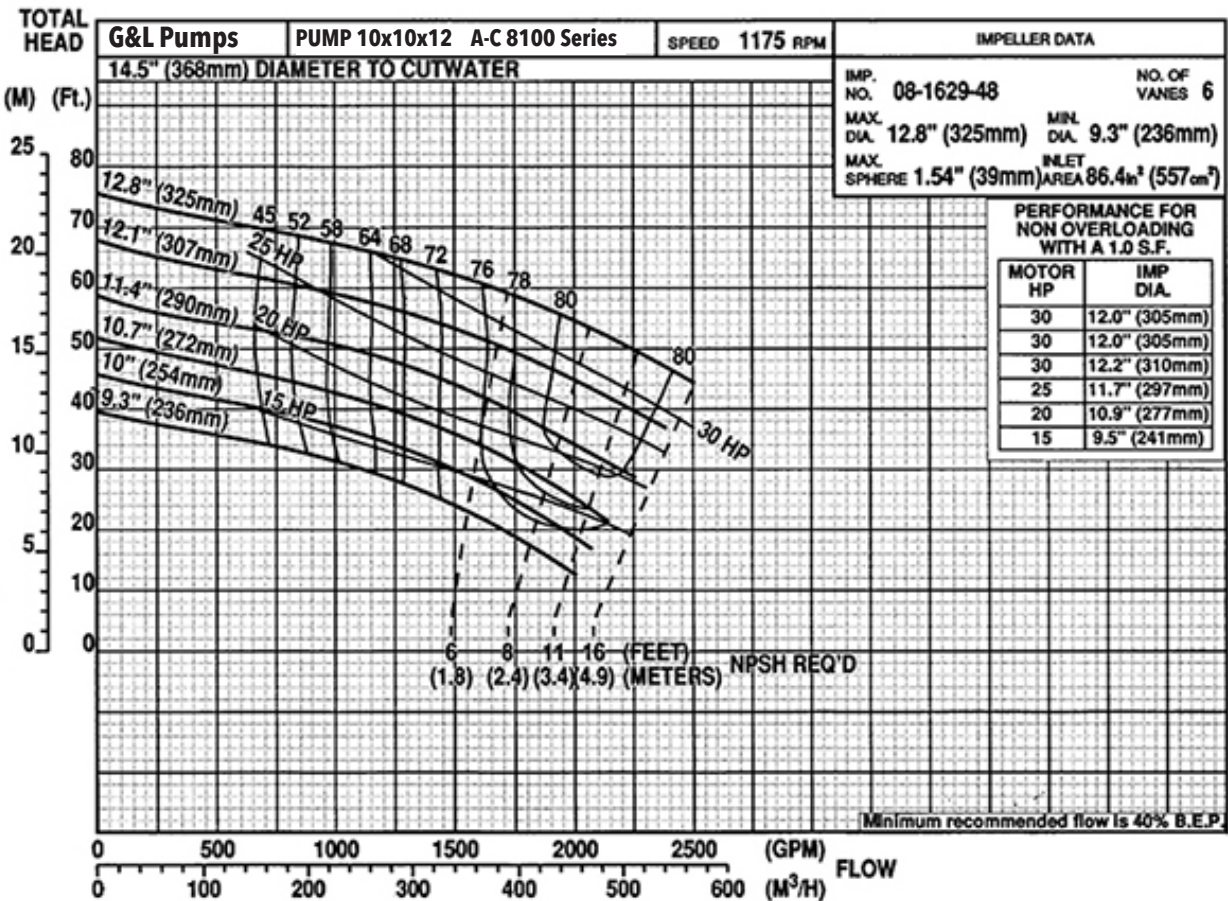
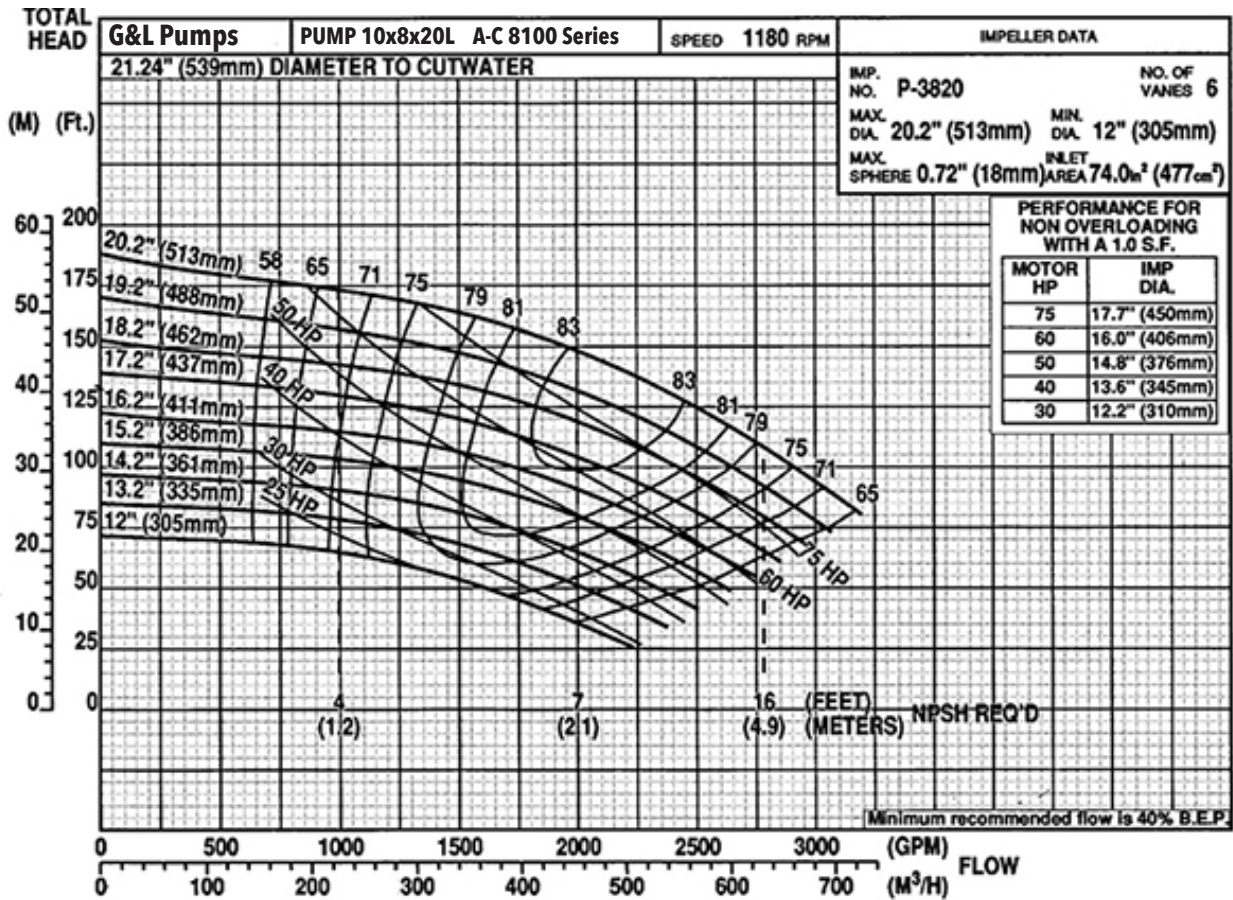

SERIES A-C 8100 - 60 Hz

1150 RPM PUMP CURVES

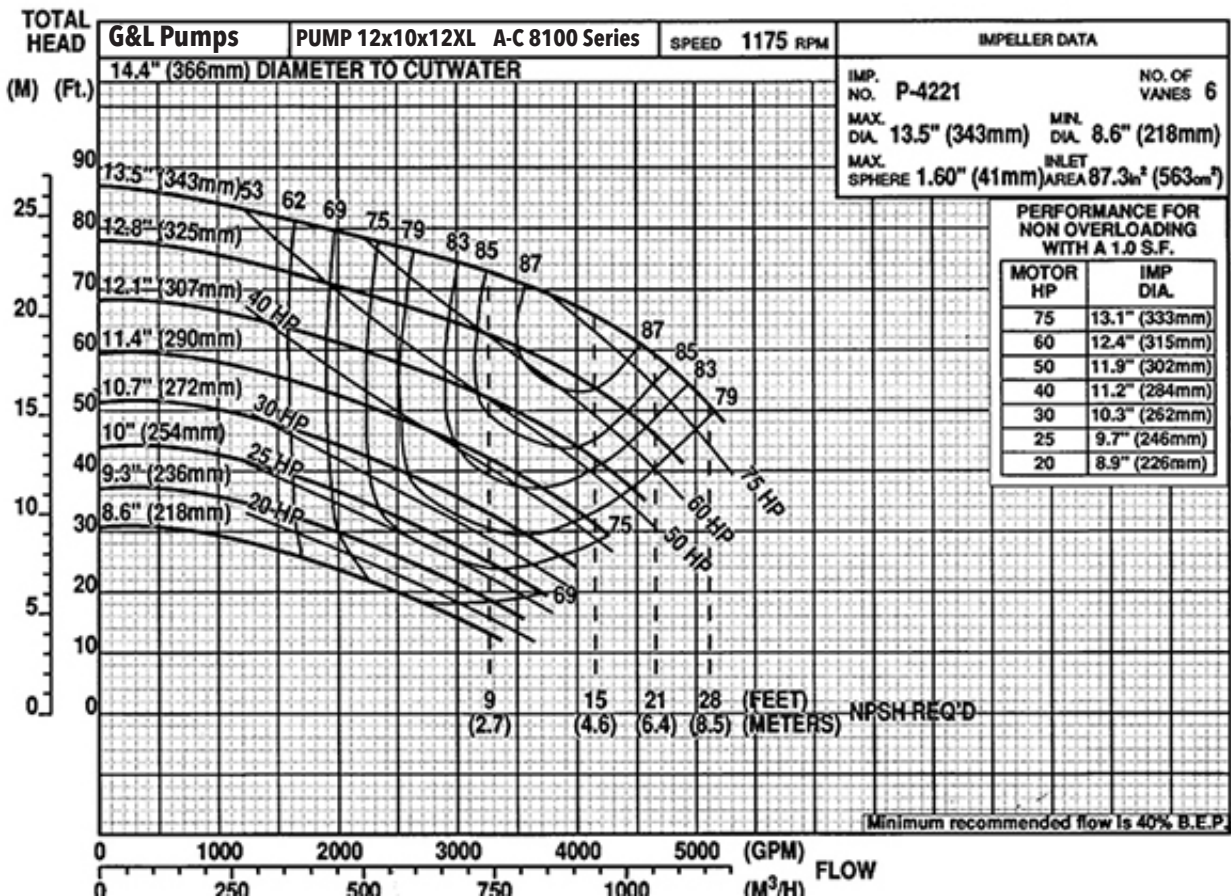
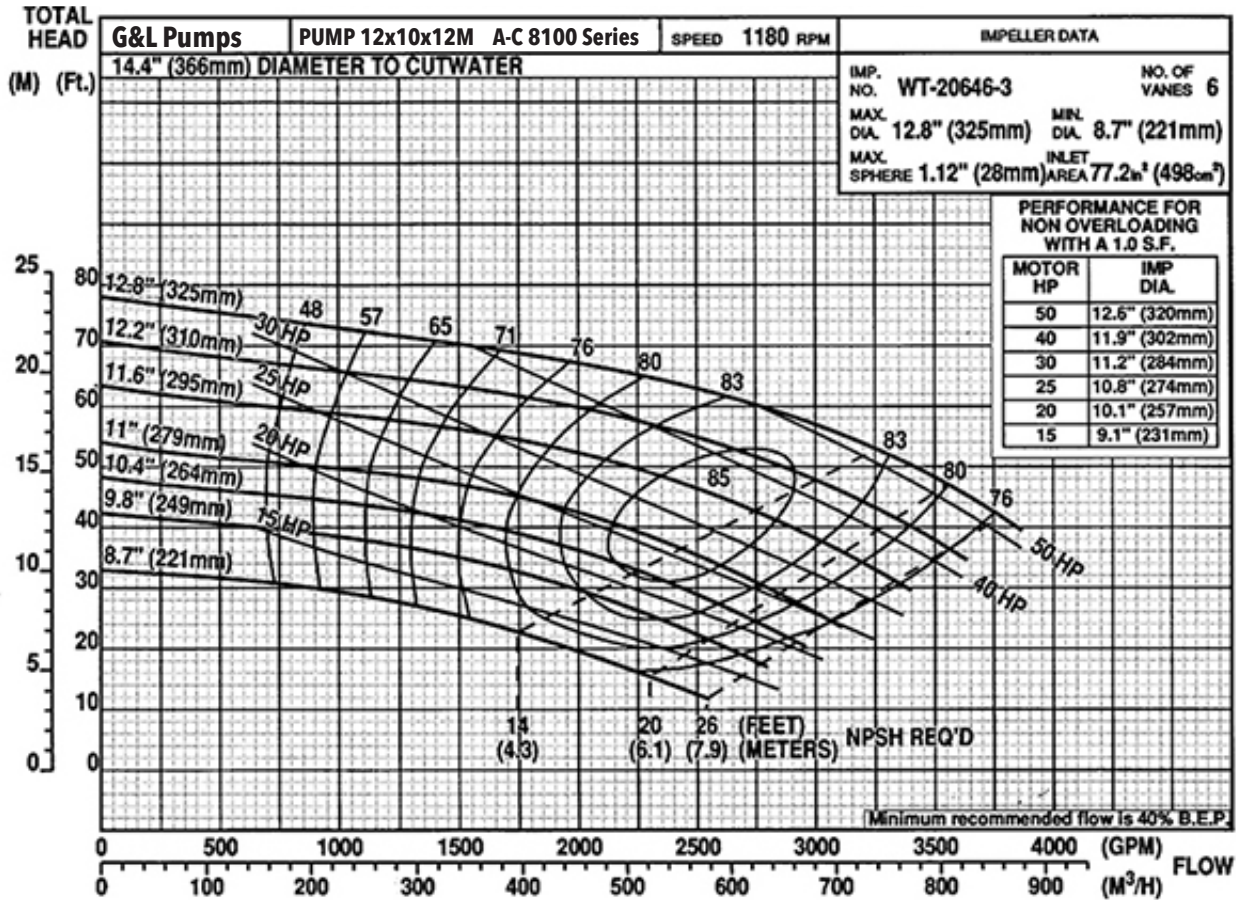

SERIES A-C 8100 - 60 Hz

1150 RPM PUMP CURVES

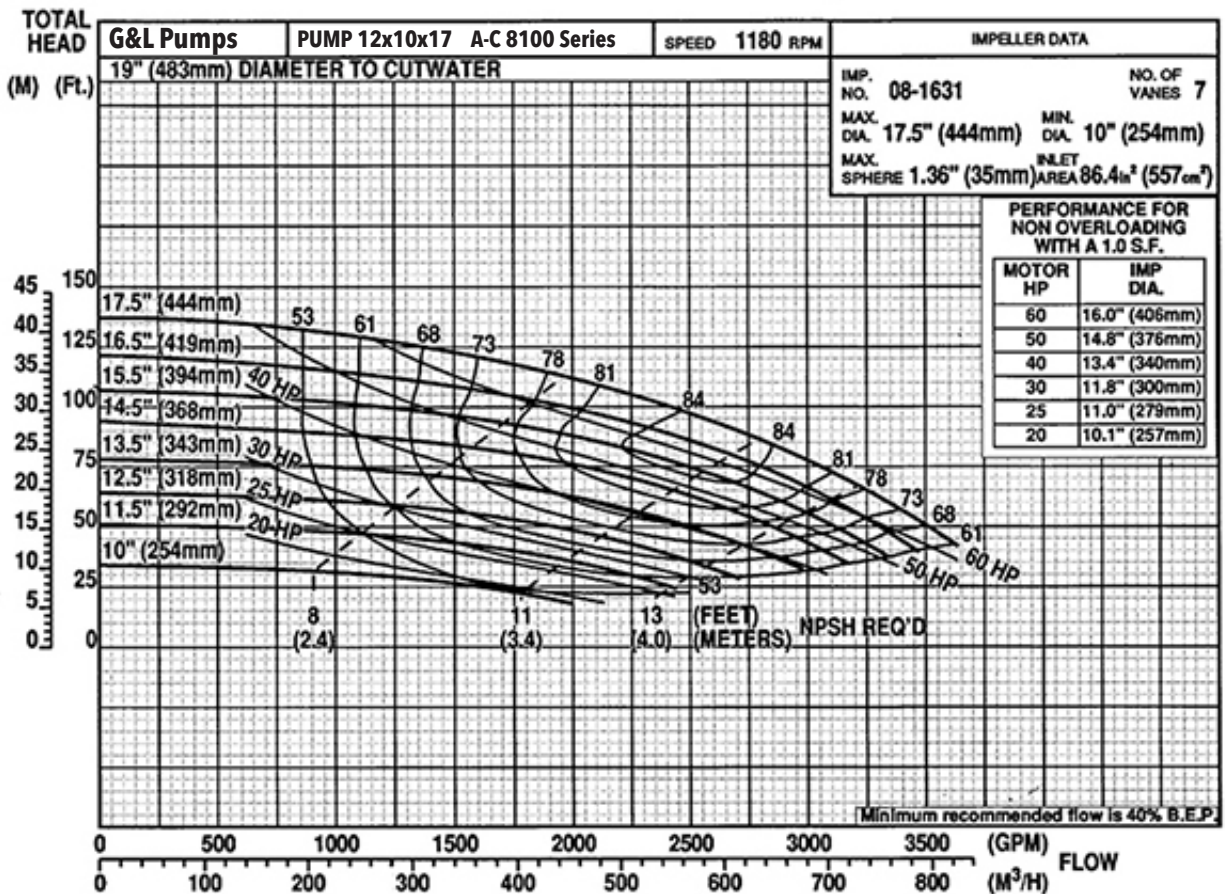
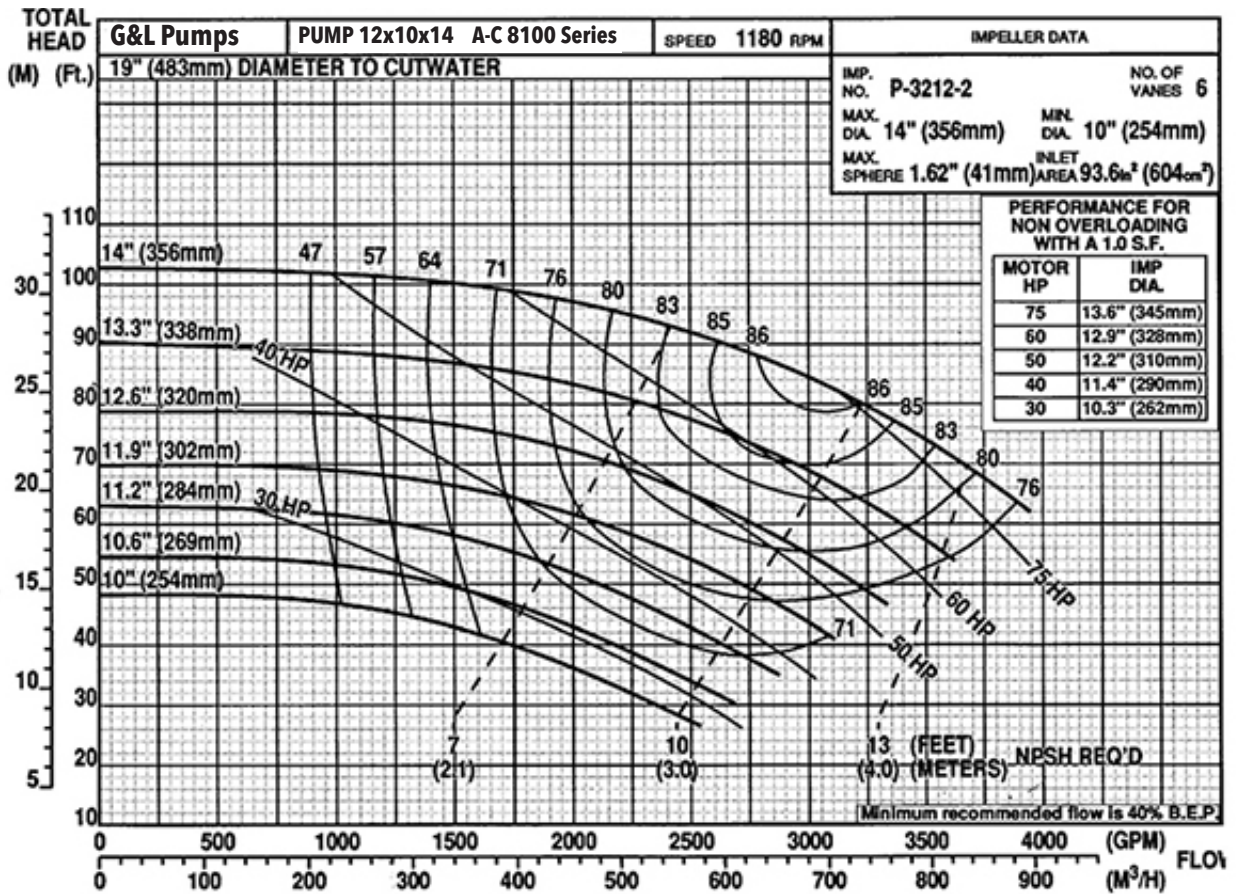

NOTES

NOTES

Xylem |'zīləm|

- 1) The tissue in plants that brings water upward from the roots;
- 2) a leading global water technology company.

We're a global team unified in a common purpose: creating advanced technology solutions to the world's water challenges. Developing new technologies that will improve the way water is used, conserved, and re-used in the future is central to our work. Our products and services move, treat, analyze, monitor and return water to the environment, in public utility, industrial, residential and commercial building services, and agricultural settings. With its October 2016 acquisition of Sensus, Xylem added smart metering, network technologies and advanced data analytics for water, gas and electric utilities to its portfolio of solutions. In more than 150 countries, we have strong, long-standing relationships with customers who know us for our powerful combination of leading product brands and applications expertise with a strong focus on developing comprehensive, sustainable solutions.

For more information on how Xylem can help you, go to www.xylem.com



Xylem Inc.
2881 East Bayard Street Ext., Suite A
Seneca Falls, NY 13148
Phone: (800) 453-6777
Fax: (888) 322-5877
www.gouldswatertechnology.com

G&L Pumps is a trademark of Xylem Inc. or one of its subsidiaries.
© 2017 Xylem Inc. GL-599 R2 October 2017